



# Tazewell County Highway Department

## AUTHORIZATION TO BID FORM

Addenda will be published to our Bid Letting page in the same manner as the plans and specifications. It is the sole responsibility of the plan holders to periodically check the website for plan addenda.

**ALL BIDDERS PLANNING TO PLACE A BID MUST FILL OUT THIS FORM TO BE AUTHORIZED TO BID.**

- This form must be completed, signed and either faxed to (309) 925-5533 or emailed to [jsciortino@tazewell-il.gov](mailto:jsciortino@tazewell-il.gov).
- Failure to submit this completed form will result in the bid not being accepted.
- Contractors may verify we have received their Authorization to Bid form by checking the **Plan Holders List** found under the corresponding letting date.
- If an email address is provided, a Notice of Addenda will be sent when updates are available.
- Bid results are typically posted by noon on the day of the letting and are preliminary until approved by the County Board on the last Wednesday of the month.

Company Name:	
Address:	
Phone:	
Fax:	
Email:	
Bid Letting Date:	

### Projects Intending to Bid on:

Section Number:	Description:



Local Public Agency Material Proposal or Deliver & Install Proposal

**Proposal Submitted By:**  
 Contractor's Name  
 Contractor's Address City State Zip Code

STATE OF ILLINOIS  
 Local Public Agency County Section Number  
 Various Road Districts Tazewell 23-XX000-00-GM  
 Street Name/Road Name Type of Funds  
 Various Routes Twp. MFT, RBI and Non-MFT

Material proposal  Deliver and Install Proposal  Plans

**For a County and Road District Project**  
 Submitted/Approved  
 Highway Commissioner Signature & Date  
 Submitted/Approved  
 County Engineer/Superintendent of Highways Signature & Date  
 Dan Parr Digitally signed by Dan Parr  
 Date: 2023.03.31 09:54:52 -05'00'

**For a Municipal Project**  
 Submitted/Approved/Passed  
 Signature & Date  
 Official Title

**Department of Transportation**  
 Released for bid based on limited review  
 Regional Engineer Signature & Date  
 [Signature] 041323

Note: All proposal documents, including Proposal Guaranty Checks or Proposal Bid Bonds, should be stapled together to prevent loss when bids are processed.

Local Public Agency	County	Section Number
Various Road Districts	Tazewell	23-XX000-00-GM

**NOTICE TO BIDDERS**

Sealed proposals for the project described below will be received at the office of the Tazewell County Engineer  
Name of Office  
21308 Illinois Route 9      Tremont, Illinois 61568      until 1:30 PM      on 05/18/23  
Address      Time      Date

1. Plans and proposal forms will be available in the office of  
Tazewell County Engineer  
21308 Illinois Route 9, Tremont, Illinois 61568

2.  Prequalification  
 If checked, the 2 low bidders must file within 24 hours after the letting an "Affidavit of Availability" (Form BC 57) in duplicate, showing all uncompleted contracts awarded to them and all low bids pending award for Federal, State, County, Municipal and private work. One original shall be filed with the Awarding Authority and one original with the IDOT District Office.
3. The Awarding Authority reserves the right to waive technicalities and to reject any or all proposals as provided in BLRS Special Provision for Bidding Requirements and Conditions for Material/Deliver and Install Proposals.
4. A proposal guaranty in the proper amount, as specified in the BLRS Special Provision for Bidding Requirements and Conditions for Material/Deliver and Install Proposals, will be required. See the attached Special Provisions for specific instructions for proposal guaranty for this proposal packet.
5. The successful bidder at the time of execution of the contract will be required to deposit a contract bond or proposal guaranty as provided for in the special provisions. Failure on the part of the contractor to deliver the material within the time specified or to do the work specified herein will be considered just cause to forfeit his surety as provided in Article 108.10 of the Standard Specifications.
6. Proposals shall be submitted on forms furnished by the Awarding Authority and shall be enclosed in an envelope endorsed "Material Proposal, Section 23-XX000-00-GM".

By Order of Awarding Authority	County Engineer/Superintendent of Highways/ Municipal Clerk	Date
<u>Tazewell County Board</u>	<u>Dan Parr, Tazewell County Engineer</u>	<u>3/31/23</u>

**Material Proposal or Deliver & Install Proposal**

To  
 Awarding Authority  
Tazewell County Board

Awarding Authority Address	City	State	Zip Code
<u>11 South 4th Street</u>	<u>Pekin</u>	<u>IL</u>	<u>61554</u>

If this bid is accepted within 45 days from the date of opening, the undersigned agrees to furnish or to deliver & install any or all of the materials, at the quoted unit prices, subject to the following:

- It is understood and agreed that the "Standard Specifications for Road and Bridge Construction", adopted 01/01/22 and the "Supplemental Specifications and Recurring Special Provisions", adopted 01/01/23, prepared by the Department of Transportation, shall govern insofar as they may be applied and insofar as they do not conflict with the special provision and supplemental specifications attached hereto.
- It is understood that quantities listed are approximate only and that they may be increased or decrease as may be needed to properly complete the improvement within its present limits or extensions thereto, at the unit prices stated and that bids will be compared on the basis of total price bid for each group.
- Delivery in total or partial shipments as ordered shall be made within the time specified in the special provisions or by the acceptance at the point and in the manner specified in the "Schedule of Prices". If delivery on the job site is specified, it shall mean any place or paces on the road designed by the awarding authority or its authorized representative.
- The contractor and/or local public agency performing the actual material placement operations shall be responsible for providing work zone traffic control, unless otherwise specified in this proposal. Such devices shall meet the requirements of and be installed in accordance with applicable provisions of the "Illinois Manual on Uniform Traffic Control Devices" and any referenced Illinois Highway Standards.

Local Public Agency

County

Section Number

Various Road Districts

Tazewell

23-XX000-00-GM

- 5. Each pay item should have a unit price and a total price. If no total price is shown or if there is a discrepancy between the product of the unit price multiplied by the quantity, the unit price shall govern. If a unit price is omitted, the total price will be divided by the quantity in order to establish a unit price. A bid will be declared unacceptable if neither a unit price nor a total price is shown.
- 6. A proposal guaranty in the proper amount, as specified in BLRS Special Provision for Bidding Requirements and Conditions for Contract Proposals, will be required. The proposal guaranty as specified in the special provisions is attached.

If a bid bond is allowed or required, Department form BLR 12230 or a proposal guaranty check, complying with the specifications, made payable to: County Treasurer of Tazewell County.

The amount of the check is \_\_\_\_\_ (\_\_\_\_\_).

**Attach Cashier's Check or Certified Check Here**

In the event that one proposal guaranty check is intended to cover two or more bid proposals, the amount must be equal to the sum of the proposal guaranties which would be required for each individual bid proposal. If the proposal guaranty check is place in another bid proposal, state below where it may be found.

The proposal guaranty check will be found in the bid proposal for: Section Number \_\_\_\_\_).

Discounts will be allowed for payment as follows: 0% 0 calendar days 0% 0 calendar days

Discounts will not be considered in determining the low bidder

Bidder

By

Title

Address

City

State

Zip Code



Local Public Agency Proposal Bid Bond

Local Public Agency: Various Road Districts; County: Tazewell; Section Number: 23-XX000-00-GM

WE, \_\_\_\_\_ as PRINCIPAL, and \_\_\_\_\_ as SURETY, are held jointly, severally and firmly bound unto the above Local Public Agency (hereafter referred to as "LPA") in the penal sum of 5% of the total bid price, or for the amount specified in the proposal documents in effect on the date of invitation for bids, whichever is the lesser sum. We bind ourselves, our heirs, executors, administrators, successors, and assigns, jointly pay to the LPA this sum under the conditions of this instrument.

WHEREAS THE CONDITION OF THE FOREGOING OBLIGATION IS SUCH that, the said PRINCIPAL is submitting a written proposal to the LPA acting through its awarding authority for the construction of the work designated as the above section.

THEREFORE if the proposal is accepted and a contract awarded to the PRINCIPAL by the LPA for the above designated section and the PRINCIPAL shall within fifteen (15) days after award enter into a formal contract, furnish surety guaranteeing the faithful performance of the work, and furnish evidence of the required insurance coverage, all as provided in the "Standard Specifications for Road and Bridge Construction" and applicable Supplemental Specifications, then this obligation shall become void; otherwise it shall remain in full force and effect.

IN THE EVENT the LPA determines the PRINCIPAL has failed to enter into a formal contract in compliance with any requirements set forth in the preceding paragraph, then the LPA acting through its awarding authority shall immediately be entitled to recover the full penal sum set out above, together with all court costs, all attorney fees, and any other expense of recovery.

IN TESTIMONY WHEREOF, the said PRINCIPAL and the said SURETY have caused this instrument to be signed by their respective officers this \_\_\_\_\_ of \_\_\_\_\_ Day Month and Year

Principal signature block: Company Name, Signature & Date, Title

Principal signature block: Company Name, Signature & Date, Title

(If Principal is a joint venture of two or more contractors, the company names, and authorized signatures of each contractor must be affixed.)

Surety signature block: Name of Surety

Surety signature block: Signature of Attorney-in-Fact Signature & Date

STATE OF IL
COUNTY OF

I \_\_\_\_\_, a Notary Public in and for said county do hereby certify that

(Insert names of individuals signing on behalf of PRINCIPAL & SURETY)

who are each personally known to me to be the same persons whose names are subscribed to the foregoing instrument on behalf of PRINCIPAL and SURETY, appeared before me this day in person and acknowledged respectively, that they signed and delivered said instruments as their free and voluntary act for the uses and purposes therein set forth.

Given under my hand and notarial seal this \_\_\_\_\_ day of \_\_\_\_\_ Month and Year

(SEAL, if required by the LPA)

Notary Public Signature & Date

Date commission expires \_\_\_\_\_





Bureau of Construction  
2300 South Dirksen Parkway/Room 322  
Springfield, IL 62764

Instructions: Complete this form by either typing or using black ink. "Authorization to Bid" will not be issued unless both sides of this form are completed in detail. Use additional forms as needed to list all work.

**Part I. Work Under Contract**

List below all work you have under contract as either a prime contractor or a subcontractor. It is required to include all pending low bids not yet awarded or rejected. In a joint venture, list only that portion of the work which is the responsibility of your company. The uncompleted dollar value is to be based upon the most recent engineer's or owners estimate, and must include work subcontracted to others. If no work is contracted, show NONE.

	1	2	3	4	Awards Pending	Accumulated Totals
Contract Number						
Contract With						
Estimated Completion Date						
Total Contract Price						
Uncompleted Dollar Value if Firm is the Prime Contractor						
Uncompleted Dollar Value if Firm is the Subcontractor						
Total Value of All Work						

**Part II. Awards Pending and Uncompleted Work to be done with your own forces.**

List below the uncompleted dollar value of work for each contract and awards pending to be completed with your own forces. All work subcontracted to others will be listed on the reverse of this form. In a joint venture, list only that portion of the work to be done by your company. If no work is contracted, show NONE.

Earthwork						
Portland Cement Concrete Paving						
HMA Plant Mix						
HMA Paving						
Clean & Seal Cracks/Joints						
Aggregate Bases, Surfaces						
Highway, R.R., Waterway Struc.						
Drainage						
Electrical						
Cover and Seal Coats						
Concrete Construction						
Landscaping						
Fencing						
Guardrail						
Painting						
Signing						
Cold Milling, Planning, Rotomilling						
Demolition						
Pavement Markings (Paint)						
Other Construction (List)						
Totals						

Disclosure of this information is REQUIRED to accomplish the statutory purpose as outlined in the "Illinois Procurement Code." Failure to comply will result in non-issuance of an "Authorization To Bid." This form has been approved by the State Forms Management Center.

**Part III. Work Subcontracted to Others.**

For each contract described in Part I, list all the work you have subcontracted to others.

	1	2	3	4	Awards Pending
Subcontractor					
Type of Work					
Subcontract Price					
Amount Uncompleted					
Subcontractor					
Type of Work					
Subcontract Price					
Amount Uncompleted					
Subcontractor					
Type of Work					
Subcontract Price					
Amount Uncompleted					
Subcontractor					
Type of Work					
Subcontract Price					
Amount Uncompleted					
Subcontractor					
Type of Work					
Subcontract Price					
Amount Uncompleted					
Total Uncompleted					

**Notary**

I, being duly sworn, do hereby declare this affidavit is a true and correct statement relating to ALL uncompleted contracts of the undersigned for Federal, State, County, City and private work, including ALL subcontract work, ALL pending low bids not yet awarded or rejected and ALL estimated completion dates.

Officer or Director

Title

Signature

Date

Company

Address

City

State

Zip Code

Subscribed and sworn to before me

this \_\_\_\_\_ day of \_\_\_\_\_, \_\_\_\_\_

\_\_\_\_\_  
(Signature of Notary Public)

My commission expires \_\_\_\_\_

(Notary Seal)

Add pages for additional contracts





Local Public Agency

County

Section Number

Various Road Districts

Tazewell

23-XX000-00-GM

**Material Proposal Schedule of Prices**

Group No.	Item(s)	Delivery	Unit	Quantity	Unit Price	Total
1.	Boynton Road District					
	Section 23-01000-01-GM					
	P BIT MATLS SE CT (CRS-2P)	Furnished & App	TON	164		
	SEAL COAT AGG (CA-16)	Furnished & App	TON	575		
	SEAL COAT AGG (EAF CM-16)	Furnished & App	TON	571		
	TRAF CONT & PROT SPL	Furnished & App	L SUM	1		
					Group 1 Total	
2.	Deer Creek Road District					
	Section 23-03000-01-GM					
	BIT MATLS SE CT (PG52-28)	Furnished & App	TON	48		
	SEAL COAT AGG (CA-16)	Furnished & App	TON	439		
	TRAF CONT & PROT SPL	Furnished & App	L SUM	1		
					Group 2 Total	
3.	Delavan Road District					
	Section 23-04000-01-GM					
	P BIT MATLS SE CT (CRS-2P)	Furnished & App	TON	48		
	SEAL COAT AGG (BLACK TRAP ROCK CA-16)	Furnished & App	TON	345		
	TRAF CONT & PROT SPL	Furnished & App	L SUM	1		
					Group 3 Total	
4.	Dillon Road District					
	Section 23-05000-01-GM					
	BIT MATLS SE CT (PG52-28)	Furnished & App	TON	70		
	SEAL COAT AGG (CA-16)	Furnished & App	TON	631		
	TRAF CONT & PROT SPL	Furnished & App	L SUM	1		
					Group 4 Total	

Various Road Districts

Tazewell

23-XX000-00-GM

Group No.	Item(s)	Delivery	Unit	Quantity	Unit Price	Total
5.	Elm Grove Road District					
	Section 23-06000-01-GM					
	P BIT MATLS SE CT (CRS-2P)	Furnished & App	TON	126		
	SEAL COAT AGG (EAF CM-16)	Furnished & App	TON	811		
	TRAF CONT & PROT SPL	Furnished & App	L SUM	1		
					Group 5 Total	
6.	Fondulac Road District					
	Section 23-07000-01-GM					
	P BIT MATLS SE CT (CRS-2P)	Furnished & App	TON	36		
	SEAL COAT AGG (BLACK TRAP ROCK CA-16)	Furnished & App	TON	258		
	TRAF CONT & PROT SPL	Furnished & App	L SUM	1		
					Group 6 Total	
7.	Hittle Road District					
	Section 23-09000-01-GM					
	P BIT MATLS SE CT (CRS-2P)	Furnished & App	TON	27		
	SEAL COAT AGG (CA-16)	Furnished & App	TON	206		
	TRAF CONT & PROT SPL	Furnished & App	L SUM	1		
					Group 7 Total	
8.	Little Mackinaw Road District					
	Section 23-11000-01-GM					
	BIT MATLS SE CT (PG52-28)	Furnished & App	TON	56		
	SEAL COAT AGG (CA-16)	Furnished & App	TON	504		
	TRAF CONT & PROT SPL	Furnished & App	L SUM	1		
					Group 8 Total	
9.	Malone Road District					
	Section 23-13000-01-GM					
	BIT MATLS SE CT (PG52-28)	Furnished & App	TON	70		
	SEAL COAT AGG (CA-16)	Furnished & App	TON	637		
	TRAF CONT & PROT SPL	Furnished & App	L SUM	1		
					Group 9 Total	

Local Public Agency

County

Section Number

Various Road Districts

Tazewell

23-XX000-00-GM

Group No.	Item(s)	Delivery	Unit	Quantity	Unit Price	Total
10.	Sand Prairie Road District					
	Section 23-16000-01-GM					
	BIT MATLS C&S CT (PG52-28)	Furnished & App	TON	114		
	COVER COAT AGG (CA-14)	Furnished & App	TON	15		
	SEAL COAT AGG (CA-16)	Furnished & App	TON	1,017		
	TRAF CONT & PROT SPL	Furnished & App	L SUM	1		
					Group 10 Total	
11.	Spring Lake Road District					
	Section 23-17000-01-GM					
	BIT MATLS SE CT (PG52-28)	Furnished & App	TON	119		
	SEAL COAT AGG (CA-16)	Furnished & App	TON	1,075		
	TRAF CONT & PROT SPL	Furnished & App	L SUM	1		
					Group 11 Total	

The undersigned firm certifies that it has not been convicted of bribery or attempting to bribe an officer or employee of the State of Illinois, nor has the firm made an admission of guilt of such conduct which is a matter of record, nor has an official, agent, or employee of the firm committed bribery or attempted bribery on behalf of the firm and pursuant to the direction or authorization of a responsible official of the firm. The undersigned firm further certifies that it is not barred from contracting with any unit of State or local government as a result of a violation of State laws prohibiting bid-rigging or bid rotating.

Bidder Signature &amp; Date

Address

City

State

Zip Code



# Apprenticeship and Training Program Certification

Local Public Agency	County	Street Name/Road Name	Section Number
Various Road Districts	Tazewell	Various	23-XX000-00-GM

**All contractors are required to complete the following certification**

- For this contract proposal or for all bidding groups in this deliver and install proposal.
- For the following deliver and install bidding groups in this material proposal.

Illinois Department of Transportation policy, adopted in accordance with the provisions of the Illinois Highway Code, requires this contract to be awarded to the lowest responsive and responsible bidder. The award decision is subject to approval by the Department. In addition to all other responsibility factors, this contract or deliver and install proposal requires all bidders and all bidder's subcontractors to disclose participation in apprenticeship or training programs that are (1) approved by and registered with the United States Department of Labor's Bureau of Apprenticeship and Training, and (2) applicable to the work of the above indicated proposals or groups. Therefore, all bidders are required to complete the following certification:

1. Except as provided in paragraph 4 below, the undersigned bidder certifies that it is a participant, either as an individual or as part of a group program, in an approved apprenticeship or training program applicable to each type of work or craft that the bidder will perform with its own employees.
2. The undersigned bidder further certifies, for work to be performed by subcontract, that each of its subcontractors either (A) is, at the time of such bid, participating in an approved, applicable apprenticeship or training program; or (B) will, prior to commencement of performance of work pursuant to this contract, establish participation in an approved apprenticeship or training program applicable to the work of the subcontract.
3. The undersigned bidder, by inclusion in the list in the space below, certifies the official name of each program sponsor holding the Certificate of Registration for all of the types of work or crafts in which the bidder is a participant and that will be performed with the bidder's employees. Types of work or craft that will be subcontracted shall be included and listed as subcontract work. The list shall also indicate any type of work or craft job category for which there is no applicable apprenticeship or training program available.

4. Except for any work identified above, if any bidder or subcontractor shall perform all or part of the work of the contract or deliver and install proposal solely by individual owners, partners or members and not by employees to whom the payment of prevailing rates of wages would be required, check the following box, and identify the owner/operator workforces and positions of ownership.

The requirements of this certification and disclosure are a material part of the contract, and the contractor shall require this certification provision to be included in all approved subcontracts. The bidder is responsible for making a complete report and shall make certain that each type of work or craft job category that will be utilized on the project is accounted for and listed. The Department at any time before or afterward may require the production of a copy of each applicable Certificate of Registration issued by the United States Department of Labor evidencing such participation by the contractor and any or all of its subcontractors. In order to fulfill the participation requirement, it shall not be necessary that any applicable program sponsor be currently taking or that it will take applications for apprenticeship, training or employment during the performance of the work of this contract or deliver and install proposal.

Bidder	Signature & Date		
<div style="border: 1px solid black; height: 20px;"></div>	<div style="border: 1px solid black; height: 40px;"></div>		
Title			
<div style="border: 1px solid black; height: 20px;"></div>			
Address	City	State	Zip Code
<div style="border: 1px solid black; height: 20px;"></div>	<div style="border: 1px solid black; height: 20px;"></div>	<div style="border: 1px solid black; height: 20px;"></div>	<div style="border: 1px solid black; height: 20px;"></div>



**Affidavit of Illinois Business Office**

Local Public Agency	County	Street Name/Road Name	Section Number
Various Road Districts	Tazewell	Various	23-XX000-00-GM

I, \_\_\_\_\_ of \_\_\_\_\_, \_\_\_\_\_,  
Name of Affiant City of Affiant State of Affiant  
 being first duly sworn upon oath, state as follows:

1. That I am the \_\_\_\_\_ of \_\_\_\_\_.  
Officer or Position Bidder
2. That I have personal knowledge of the facts herein stated.
3. That, if selected under the proposal described above, \_\_\_\_\_, will maintain a business office in the  
Bidder  
 State of Illinois, which will be located in \_\_\_\_\_ County, Illinois.  
County
4. That this business office will serve as the primary place of employment for any persons employed in the construction contemplated by this proposal.
5. That this Affidavit is given as a requirement of state law as provided in Section 30-22(8) of the Illinois Procurement Code.

Signature & Date

Print Name of Affiant

**Notary Public**

State of IL  
 County \_\_\_\_\_

Signed (or subscribed or attested) before me on \_\_\_\_\_ by  
(date)

\_\_\_\_\_, authorized agent(s) of  
(name/s of person/s)  
 \_\_\_\_\_  
Bidder

(SEAL)

Notary Public Signature & Date

My commission expires \_\_\_\_\_

INDEX  
FOR  
SUPPLEMENTAL SPECIFICATIONS  
AND RECURRING SPECIAL PROVISIONS

Adopted January 1, 2023

This index contains a listing of SUPPLEMENTAL SPECIFICATIONS and frequently used RECURRING SPECIAL PROVISIONS.

ERRATA    Standard Specifications for Road and Bridge Construction                      (Adopted 1-1-22) (Revised 1-1-23)

SUPPLEMENTAL SPECIFICATIONS

<u>Std. Spec. Sec.</u>	<u>Page No.</u>
202 Earth and Rock Excavation .....	1
204 Borrow and Furnished Excavation .....	2
207 Porous Granular Embankment .....	3
211 Topsoil and Compost .....	4
407 Hot-Mix Asphalt Pavement (Full-Depth) .....	5
420 Portland Cement Concrete Pavement .....	6
502 Excavation for Structures .....	7
509 Metal Railings .....	8
540 Box Culverts .....	9
542 Pipe Culverts .....	29
586 Granular Backfill for Structures .....	34
644 High Tension Cable Median Barrier .....	35
782 Reflectors .....	36
801 Electrical Requirements .....	38
821 Roadway Luminaires .....	40
1003 Fine Aggregates .....	41
1004 Coarse Aggregates .....	42
1020 Portland Cement Concrete .....	43
1030 Hot-Mix Asphalt .....	44
1067 Luminaire .....	45
1097 Reflectors .....	52



## Check Sheet for Recurring Special Provisions

Local Public Agency	County	Section Number
Various Road Districts	Tazewell	23-XX000-00-GM

Check this box for lettings prior to 01/01/2023.

The Following Recurring Special Provisions Indicated By An "X" Are Applicable To This Contract And Are Included By Reference:

Recurring Special Provisions

<u>Check Sheet #</u>		<u>Page No.</u>
1	<input type="checkbox"/> Additional State Requirements for Federal-Aid Construction Contracts	53
2	<input type="checkbox"/> Subletting of Contracts (Federal-Aid Contracts)	56
3	<input type="checkbox"/> EEO	57
4	<input type="checkbox"/> Specific EEO Responsibilities Non Federal-Aid Contracts	67
5	<input type="checkbox"/> Required Provisions - State Contracts	72
6	<input type="checkbox"/> Asbestos Bearing Pad Removal	78
7	<input type="checkbox"/> Asbestos Waterproofing Membrane and Asbestos HMA Surface Removal	79
8	<input type="checkbox"/> Temporary Stream Crossings and In-Stream Work Pads	80
9	<input type="checkbox"/> Construction Layout Stakes	81
10	<input type="checkbox"/> Use of Geotextile Fabric for Railroad Crossing	84
11	<input type="checkbox"/> Subsealing of Concrete Pavements	86
12	<input type="checkbox"/> Hot-Mix Asphalt Surface Correction	90
13	<input type="checkbox"/> Pavement and Shoulder Resurfacing	92
14	<input type="checkbox"/> Patching with Hot-Mix Asphalt Overlay Removal	93
15	<input type="checkbox"/> Polymer Concrete	95
16	<input type="checkbox"/> Reserved	97
17	<input type="checkbox"/> Bicycle Racks	98
18	<input type="checkbox"/> Temporary Portable Bridge Traffic Signals	100
19	<input type="checkbox"/> Nighttime Inspection of Roadway Lighting	102
20	<input type="checkbox"/> English Substitution of Metric Bolts	103
21	<input type="checkbox"/> Calcium Chloride Accelerator for Portland Cement Concrete	104
22	<input type="checkbox"/> Quality Control of Concrete Mixtures at the Plant	105
23	<input type="checkbox"/> Quality Control/Quality Assurance of Concrete Mixtures	113
24	<input type="checkbox"/> Reserved	129
25	<input type="checkbox"/> Reserved	130
26	<input type="checkbox"/> Temporary Raised Pavement Markers	131
27	<input type="checkbox"/> Restoring Bridge Approach Pavements Using High-Density Foam	132
28	<input type="checkbox"/> Portland Cement Concrete Inlay or Overlay	135
29	<input type="checkbox"/> Portland Cement Concrete Partial Depth Hot-Mix Asphalt Patching	139
30	<input type="checkbox"/> Longitudinal Joint and Crack Patching	142
31	<input type="checkbox"/> Concrete Mix Design - Department Provided	144
32	<input type="checkbox"/> Station Numbers in Pavements or Overlays	145

Local Public Agency

County

Section Number

Various Road Districts

Tazewell

23-XX000-00-GM

The Following Local Roads And Streets Recurring Special Provisions Indicated By An "X" Are Applicable To This Contract And Are Included By Reference:

Local Roads And Streets Recurring Special Provisions

<u>Check Sheet #</u>		<u>Page No.</u>
LRS 1	<b>Reserved</b>	147
LRS 2	<input type="checkbox"/> Furnished Excavation	148
LRS 3	<input checked="" type="checkbox"/> Work Zone Traffic Control Surveillance	149
LRS 4	<input checked="" type="checkbox"/> Flaggers in Work Zones	150
LRS 5	<input checked="" type="checkbox"/> Contract Claims	151
LRS 6	<input type="checkbox"/> Bidding Requirements and Conditions for Contract Proposals	152
LRS 7	<input checked="" type="checkbox"/> Bidding Requirements and Conditions for Material Proposals	158
LRS 8	<b>Reserved</b>	164
LRS 9	<input checked="" type="checkbox"/> Bituminous Surface Treatments	165
LRS 10	<b>Reserved</b>	169
LRS 11	<input checked="" type="checkbox"/> Employment Practices	170
LRS 12	<input checked="" type="checkbox"/> Wages of Employees on Public Works	172
LRS 13	<input checked="" type="checkbox"/> Selection of Labor	174
LRS 14	<input type="checkbox"/> Paving Brick and Concrete Paver Pavements and Sidewalks	175
LRS 15	<input checked="" type="checkbox"/> Partial Payments	178
LRS 16	<input type="checkbox"/> Protests on Local Lettings	179
LRS 17	<input checked="" type="checkbox"/> Substance Abuse Prevention Program	180
LRS 18	<input type="checkbox"/> Multigrade Cold Mix Asphalt	181
LRS 19	<input type="checkbox"/> Reflective Crack Control Treatment	182



## TABLE OF CONTENTS

Page 1	Description of Work Proposal Guaranty Traffic Traffic Control Plan
Page 2	Traffic Control Plan (Cont'd.) Bituminous Surface Treatment, Class A
Page 3	Bituminous Surface Treatment, Class A (Cont'd.) Weight Limits
Page 4	Pre-Construction Meeting Liquidated Damages Time Schedule Wages of Employees on Public Works
Page 5-6	BDE Special Provisions Check Sheets
Page 7-12	BDE Special Provisions
Page 13-18	LR Special Provisions
Page 19-40	Project Location Maps & Quantity Sheets
Page 41	Highway Standard 701011-04
Page 42	Highway Standard 701306-04
Page 43-45	Highway Standard 701901-08



Local Public Agency	County	Section Number
Various Road Districts	Tazewell	23-XX000-00-GM

The following Special Provision supplement the "Standard Specifications for Road and Bridge Construction", adopted

January 1, 2022

, the latest edition of the "Manual on Uniform Traffic Control Devices for Streets and Highways", and the "Manual of Test Procedures of Materials" in effect on the date of invitation of bids, and the Supplemental Specification and Recurring Special Provisions indicated on the Check Sheet included here in which apply to and govern the construction of the above named section, and in case of conflict with any parts, or parts of said Specifications, the said Special Provisions shall take precedence and shall govern.

**DESCRIPTION OF WORK:** The work for all groups in this Section consists of the construction of a Bituminous Surface Treatment, Class A-1 and/or Class A-2 over existing bituminous surfaces.

**PROPOSAL GUARANTY:** A proposal guaranty in the proper amount, as specified in the BLRS Special Provision for Bidding Requirements and Conditions for Material Proposals, will be required.

**TRAFFIC:** The roads shall remain open for both local and through traffic.

**TRAFFIC CONTROL PLAN:** Traffic Control shall be in accordance with the applicable sections of the "Standard Specifications for Road and Bridge Construction", the applicable guidelines contained in the "Manual on Uniform Traffic Control Devices for Streets and Highways", these Special Provisions, and any special details and Highway Standards contained herein and in the plans.

Special attention is called to Articles 107.09, 107.14, 107.15 and Section 1106 of the "Standard Specifications for Road and Bridge Construction" and the Traffic Control Standards 701011-04, 701306-04 and 701901-08.

The Contractor shall post the construction routes with "LOOSE GRAVEL" and "SPEED LIMIT 35" signs immediately prior to Bituminous Surface Treatment, Class A-1 and/or Class A-2 operations in accordance with applicable articles of Division 700 of the Standard Specifications. The signs shall be placed at the start of the work, near intersecting roadways and then at an average spacing of 0.50 miles. These signs may be removed as soon as the final sweeping operation has been completed or at the direction of the Engineer.

The presence of temporary traffic control drawings or standards in the proposal or contract, whether a pay item or not, does not relieve the Contractor of his obligation to the public. The Contractor shall provide, if conditions warrant by the Engineer, all protection deemed necessary beyond that shown in the proposal or Special Provisions.

The Contractor shall be responsible for all traffic control operations as follows:

1. The Contractor shall provide two flaggers and two pickup trucks, each equipped with a mounted yellow flashing light, a mounted "Road Closed" sign (R11-2), a mounted "Fresh Oil" sign (W21-2), and a "Flagger Traffic Control Sign" (Stop/Slow paddle). These flaggers shall be placed at the intersection immediately ahead of and behind the seal coat operation to control the traffic. Flaggers must hold the "Flagger Traffic Control Sign" (Stop/Slow paddle).
2. The Contractor must equip all of their oil distributors, chip spreaders and rollers with a mounted yellow flashing light.
3. The Contractor shall equip all of their rollers with a "Fresh Oil" sign (W21-2).

4. The Contractor shall place a "Road Closed Ahead" sign (W20-3) 750 feet prior to the intersection where the required pickup truck is controlling traffic if the pickup truck is not visible at that point to oncoming traffic.

Basis of payment: All Traffic Control shall be paid for at the contract-lump sum price for TRAFFIC CONTROL AND PROTECTION, (SPECIAL)

**BITUMINOUS SURFACE TREATMENT, CLASS A:** This work shall conform to the applicable portions of Check Sheet #LRS9, Special Provisions for Bituminous Surface Treatments, of the "Supplemental Specifications and Recurring Special Provisions", with the following exceptions and inclusions:

MATERIALS- Add the following:

The Bituminous Materials shall be CRS-2P where specified on the quantity sheets.

The Bituminous Materials shall be PG52-28 where specified on the quantity sheets.

The Cover Coat Aggregate shall be CA-14 where specified on the quantity sheet for Group #10 Sand Prairie Road District (Section 23-16000-01-GM).

The Seal Coat Aggregate shall be CA-16 where specified on the quantity sheets.

The Seal Coat Aggregate shall be Black Trap Rock where specified on the quantity sheets and shall meet the requirements of CA-16 with the following additions and changes:

Trap Rock shall be made up of Igneous Rock composed of Rhyolite porphyry and meet the following quality standards:

Hardness greater than 5.0 Mohs  
 Soundness less than 5% loss (5 Cycle Sodium Sulfate)  
 L.A. Abrasion less than 20% loss  
 Absorption less than 1.0%  
 Loss on Ignition less than 1.0%  
 Mill Abrasion less than 6% loss

The Seal Coat Aggregate shall be Electric Air Furnace Slag CM-16 in accordance with Article 1004.01 (a) (10) where specified on the quantity sheets.

APPLICATION: Rates per Square Yard (Estimated)

When using CRS-2P for Bituminous Surface Treatment, Class A-1:

Polymerized Bituminous Materials- Seal Coat	- 0.42 gallon (CA-16)
Seal Coat Aggregate	- 24 pounds (CA-16)
Polymerized Bituminous Materials- Seal Coat	- 0.44 gallon (BLACK TRAP ROCK CA-16)
Seal Coat Aggregate	- 27 pounds (BLACK TRAP ROCK CA-16)
Polymerized Bituminous Materials- Seal Coat	- 0.55 gallon (EAF CM-16)
Seal Coat Aggregate (EAF CM-16)	- 30 pounds (EAF CM-16)

When using PG52-28 for Bituminous Surface Treatment, Class A-1:

Bituminous Materials- Seal Coat	- 0.31 gallon (CA-16)
Seal Coat Aggregate	- 24 pounds (CA-16)

When using PG52-28 for Bituminous Surface Treatment, Class A-2:

Bituminous Materials- Cover Coat	- 0.33 gallon (CA-14)
Bituminous Materials- Seal Coat	- 0.31 gallon (CA-16)
Cover Coat Aggregate	- 26 pounds (CA-14)
Seal Coat Aggregate	- 24 pounds (CA-16)

EQUIPMENT- Add the following:

(a) Rollers- Rollers shall include both a Pneumatic-Tired Roller meeting the requirements of Article 1101.01 (a) and either a Tandem Roller or a Three Wheel Roller meeting the requirements of Article 1101.01 (e).

(b) Mechanical Sweeper- The mechanical sweeper for Group #5 Elm Grove Road District (Section 23-06000-01-GM) shall be a vacuum type which collects the loose material that is swept from the surface meeting the requirements of Article 1101.03.

SEQUENCE OF WORK: Change item (a) as follows: Mechanical power sweeping of surface is required prior to Bituminous Surface Treatment, Class A-1 and/or Class A-2 applications. Where noted below, a pick-up sweeper shall be used for Group #5 Elm Grove Road District (Section 23-06000-01-GM) under the following provisions:

- 1) Prior to placement of Bituminous Surface Treatment, Class A-1 on all routes for this project. Please see quantity sheet for locations.
- 2) Ten days after placement of Bituminous Surface Treatment, Class A-1 on all routes for this project. Please see quantity sheet for locations.
- 3) Shall be included in the cost of the project.

SEAL COAT- Add the following:

Final sweeping shall not commence until 10 days after seal coat work is completed or at the direction of the Engineer.

Basis of Payment: This work will be paid for at the contract unit price per ton for BITUMINOUS MATERIALS (COVER AND SEAL COATS) PG52-28, BITUMINOUS MATERIALS (SEAL COAT) PG52-28, POLYMERIZED BITUMINOUS MATERIALS (SEAL COAT) CRS-2P, COVER COAT AGGREGATE (CA-14), SEAL COAT AGGREGATE (BLACK TRAP ROCK CA-16), SEAL COAT AGGREGATE (CA-16) AND SEAL COAT AGGREGATE (EAF CM-16).

**WEIGHT LIMITS:** Legal weight limits shall be observed on all township roads and the structures they contain at all times.

Local Public Agency	County	Section Number
Various Road Districts	Tazewell	23-XX000-00-GM

**PRE-CONSTRUCTION MEETING:** A pre-construction meeting for all groups in this Section is required.

**LIQUIDATED DAMAGES:** Liquidated damages shall be assessed in accordance with Article 108.09 of the "Standard Specifications for Road and Bridge Construction".

**TIME SCHEDULE:** The specified completion date for all groups in this Section is August 15, 2023 with the exception of Group #4 Dillon Road District (Section 23-04000-01-GM) whereas the specified completion date shall be August 1, 2023.

**WAGES OF EMPLOYEES ON PUBLIC WORKS:** Add the following to paragraph #1 of the Special Provision for Wages of Employees on Public Works, Check Sheet LRS#12: Prevailing wage rates may be obtained from the IDOL (Illinois Department of Labor) website at:

<https://www2.illinois.gov/idol/Laws-Rules/CONMED/Pages/Rates.aspx>

BDE SPECIAL PROVISIONS  
For the April 28, 2023 and June 16, 2023 Lettings

The following special provisions indicated by a “check mark” are applicable to this contract and will be included by the Project Coordination and Implementation Section of the Bureau of Design & Environment (BDE).

File Name	#		Special Provision Title	Effective	Revised
	80099	1	<input type="checkbox"/> Accessible Pedestrian Signals (APS)	April 1, 2003	Jan. 1, 2022
	80274	2	<input type="checkbox"/> Aggregate Subgrade Improvement	April 1, 2012	April 1, 2022
	80192	3	<input checked="" type="checkbox"/> Automated Flagger Assistance Devices	Jan. 1, 2008	April 1, 2023
	80173	4	<input type="checkbox"/> Bituminous Materials Cost Adjustments	Nov. 2, 2006	Aug. 1, 2017
	80426	5	<input type="checkbox"/> Bituminous Surface Treatment with Fog Seal	Jan. 1, 2020	Jan. 1, 2022
	80436	6	<input type="checkbox"/> Blended Finely Divided Minerals	April 1, 2021	
*	80241	7	<input type="checkbox"/> Bridge Demolition Debris	July 1, 2009	
*	50531	8	<input type="checkbox"/> Building Removal	Sept. 1, 1990	Aug. 1, 2022
*	50261	9	<input type="checkbox"/> Building Removal with Asbestos Abatement	Sept. 1, 1990	Aug. 1, 2022
	80384	10	<input checked="" type="checkbox"/> Compensable Delay Costs	June 2, 2017	April 1, 2019
*	80198	11	<input type="checkbox"/> Completion Date (via calendar days)	April 1, 2008	
*	80199	12	<input type="checkbox"/> Completion Date (via calendar days) Plus Working Days	April 1, 2008	
	80261	13	<input type="checkbox"/> Construction Air Quality – Diesel Retrofit	June 1, 2010	Nov. 1, 2014
	80434	14	<input type="checkbox"/> Corrugated Plastic Pipe (Culvert and Storm Sewer)	Jan. 1, 2021	
*	80029	15	<input type="checkbox"/> Disadvantaged Business Enterprise Participation	Sept. 1, 2000	Mar. 2, 2019
	80229	16	<input type="checkbox"/> Fuel Cost Adjustment	April 1, 2009	Aug. 1, 2017
	80447	17	<input type="checkbox"/> Grading and Shaping Ditches	Jan. 1, 2023	
	80433	18	<input type="checkbox"/> Green Preformed Thermoplastic Pavement Markings	Jan. 1, 2021	Jan. 1, 2022
	80443	19	<input type="checkbox"/> High Tension Cable Median Barrier Removal	April 1, 2022	
	80446	20	<input type="checkbox"/> Hot-Mix Asphalt - Longitudinal Joint Sealant	Nov. 1, 2022	
	80438	21	<input type="checkbox"/> Illinois Works Apprenticeship Initiative – State Funded Contracts	June 2, 2021	Sept. 2, 2021
	80045	22	<input type="checkbox"/> Material Transfer Device	June 15, 1999	Jan. 1, 2022
	80441	23	<input type="checkbox"/> Performance Graded Asphalt Binder	Jan. 1, 2023	
*	34261	24	<input type="checkbox"/> Railroad Protective Liability Insurance	Dec. 1, 1986	Jan. 1, 2022
	80445	25	<input type="checkbox"/> Seeding	Nov. 1, 2022	
	80448	26	<input checked="" type="checkbox"/> Source of Supply and Quality Requirements	Jan. 2, 2023	
	80340	27	<input type="checkbox"/> Speed Display Trailer	April 2, 2014	Jan. 1, 2022
	80127	28	<input type="checkbox"/> Steel Cost Adjustment	April 2, 2004	Jan. 1, 2022
	80397	29	<input type="checkbox"/> Subcontractor and DBE Payment Reporting	April 2, 2018	
	80391	30	<input checked="" type="checkbox"/> Subcontractor Mobilization Payments	Nov. 2, 2017	April 1, 2019
	80437	31	<input type="checkbox"/> Submission of Payroll Records	April 1, 2021	Nov. 1, 2022
	80435	32	<input type="checkbox"/> Surface Testing of Pavements – IRI	Jan. 1, 2021	Jan. 1, 2023
	80410	33	<input type="checkbox"/> Traffic Spotters	Jan. 1, 2019	
*	20338	34	<input type="checkbox"/> Training Special Provisions	Oct. 15, 1975	Sept. 2, 2021
	80429	35	<input type="checkbox"/> Ultra-Thin Bonded Wearing Course	April 1, 2020	Jan. 1, 2022
	80439	36	<input checked="" type="checkbox"/> Vehicle and Equipment Warning Lights	Nov. 1, 2021	Nov. 1, 2022
	80440	37	<input type="checkbox"/> Waterproofing Membrane System	Nov. 1, 2021	
	80302	38	<input type="checkbox"/> Weekly DBE Trucking Reports	June 2, 2012	Nov. 1, 2021
	80427	39	<input type="checkbox"/> Work Zone Traffic Control Devices	Mar. 2, 2020	
*	80071	40	<input type="checkbox"/> Working Days	Jan. 1, 2002	

Highlighted items indicate a new or revised special provision for the letting.

An \* indicates the special provision requires additional information from the designer, which needs to be submitted separately. The Project Coordination and Implementation Section will then include the information in the applicable special provision.

The following special provisions have been deleted from use.

<u>File Name</u>	<u>Special Provision Title</u>	<u>Effective</u>	<u>Revised</u>
50481	Building Removal-Case II (Non-Friable Asbestos)	Sept. 1, 1990	April 1, 2010
50491	Building Removal-Case III (Friable Asbestos)	Sept. 1, 1990	April 1, 2010

The following special provisions are in the 2023 Supplemental Specifications and Recurring Special Provisions.

<u>File Name</u>	<u>Special Provision Title</u>	<u>New Location(s)</u>	<u>Effective</u>	<u>Revised</u>
80293	Concrete Box Culverts with Skews > 30 Degrees and Design Fills ≤ 5 Feet	Articles 540.04 & 540.06	April 1, 2012	July 1, 2016
80311	Concrete End Sections for Pipe Culverts	Articles 540.07, 542.01, 542.02, 542.07, 542.11 & 542.12	Jan. 1, 2013	April 1, 2016
80422	High Tension Cable Median Barrier	Articles 644.02, 644.05, 782.01, 782.04, 782.07 & 1097.02	Jan. 1, 2020	Jan. 1, 2022
80442	Hot-Mix Asphalt	Articles 1030.09 & 1030.10	Jan. 1, 2022	Aug. 1, 2022
80444	Hot-Mix Asphalt – Patching	Errata – Article 442.08(b)	April 1, 2022	
80411	Luminaires, LED	Articles 801.05(a), 821.02(d), 821.03, 821.08 & 1067.01-1067.06	April 1, 2019	Jan. 1, 2022
80418	Mechanically Stabilized Earth Retaining Walls	Articles 1003.07 & 1004.06	Nov. 1, 2019	Nov. 1, 2020
80430	Portland Cement Concrete – Haul Time	Article 1020.11(a)(7)	July 1, 2020	
80395	Sloped Metal End Section for Pipe Culverts	Articles 540.07, 542.01, 542.02, 542.07, 542.11 & 542.12	Jan. 1, 2018	
80318	Traversable Pipe Grate for Concrete End Sections	Articles 540.04, 540.07, 540.08 & 542.01, 542.02, 542.07, 542.11 & 542.12	Jan. 1, 2013	Jan. 1, 2018

## COMPENSABLE DELAY COSTS (BDE)

Effective: June 2, 2017

Revised: April 1, 2019

Revise Article 107.40(b) of the Standard Specifications to read:

“(b) Compensation. Compensation will not be allowed for delays, inconveniences, or damages sustained by the Contractor from conflicts with facilities not meeting the above definition; or if a conflict with a utility in an unanticipated location does not cause a shutdown of the work or a documentable reduction in the rate of progress exceeding the limits set herein. The provisions of Article 104.03 notwithstanding, compensation for delays caused by a utility in an unanticipated location will be paid according to the provisions of this Article governing minor and major delays or reduced rate of production which are defined as follows.

- (1) Minor Delay. A minor delay occurs when the work in conflict with the utility in an unanticipated location is completely stopped for more than two hours, but not to exceed two weeks.
- (2) Major Delay. A major delay occurs when the work in conflict with the utility in an unanticipated location is completely stopped for more than two weeks.
- (3) Reduced Rate of Production Delay. A reduced rate of production delay occurs when the rate of production on the work in conflict with the utility in an unanticipated location decreases by more than 25 percent and lasts longer than seven calendar days.”

Revise Article 107.40(c) of the Standard Specifications to read:

“(c) Payment. Payment for Minor, Major, and Reduced Rate of Production Delays will be made as follows.

- (1) Minor Delay. Labor idled which cannot be used on other work will be paid for according to Article 109.04(b)(1) and (2) for the time between start of the delay and the minimum remaining hours in the work shift required by the prevailing practice in the area.

Equipment idled which cannot be used on other work, and which is authorized to standby on the project site by the Engineer, will be paid for according to Article 109.04(b)(4).

- (2) Major Delay. Labor will be the same as for a minor delay.

Equipment will be the same as for a minor delay, except Contractor-owned equipment will be limited to two weeks plus the cost of move-out to either the



Contractor's yard or another job and the cost to re-mobilize, whichever is less. Rental equipment may be paid for longer than two weeks provided the Contractor presents adequate support to the Department (including lease agreement) to show retaining equipment on the job is the most economical course to follow and in the public interest.

- (3) Reduced Rate of Production Delay. The Contractor will be compensated for the reduced productivity for labor and equipment time in excess of the 25 percent threshold for that portion of the delay in excess of seven calendar days. Determination of compensation will be in accordance with Article 104.02, except labor and material additives will not be permitted.

Payment for escalated material costs, escalated labor costs, extended project overhead, and extended traffic control will be determined according to Article 109.13.”

Revise Article 108.04(b) of the Standard Specifications to read:

“(b) No working day will be charged under the following conditions.

- (1) When adverse weather prevents work on the controlling item.
- (2) When job conditions due to recent weather prevent work on the controlling item.
- (3) When conduct or lack of conduct by the Department or its consultants, representatives, officers, agents, or employees; delay by the Department in making the site available; or delay in furnishing any items required to be furnished to the Contractor by the Department prevents work on the controlling item.
- (4) When delays caused by utility or railroad adjustments prevent work on the controlling item.
- (5) When strikes, lock-outs, extraordinary delays in transportation, or inability to procure critical materials prevent work on the controlling item, as long as these delays are not due to any fault of the Contractor.
- (6) When any condition over which the Contractor has no control prevents work on the controlling item.”

Revise Article 109.09(f) of the Standard Specifications to read:

“(f) Basis of Payment. After resolution of a claim in favor of the Contractor, any adjustment in time required for the work will be made according to Section 108. Any adjustment in the costs to be paid will be made for direct labor, direct materials, direct equipment, direct jobsite overhead, direct offsite overhead, and other direct costs allowed by the resolution. Adjustments in costs will not be made for interest charges, loss of anticipated profit, undocumented loss of efficiency, home office overhead and unabsorbed overhead

other than as allowed by Article 109.13, lost opportunity, preparation of claim expenses and other consequential indirect costs regardless of method of calculation.

The above Basis of Payment is an essential element of the contract and the claim cost recovery of the Contractor shall be so limited.”

Add the following to Section 109 of the Standard Specifications.

**“109.13 Payment for Contract Delay.** Compensation for escalated material costs, escalated labor costs, extended project overhead, and extended traffic control will be allowed when such costs result from a delay meeting the criteria in the following table.

Contract Type	Cause of Delay	Length of Delay
Working Days	Article 108.04(b)(3) or Article 108.04(b)(4)	No working days have been charged for two consecutive weeks.
Completion Date	Article 108.08(b)(1) or Article 108.08(b)(7)	The Contractor has been granted a minimum two week extension of contract time, according to Article 108.08.

Payment for each of the various costs will be according to the following.

- (a) Escalated Material and/or Labor Costs. When the delay causes work, which would have otherwise been completed, to be done after material and/or labor costs have increased, such increases will be paid. Payment for escalated material costs will be limited to the increased costs substantiated by documentation furnished by the Contractor. Payment for escalated labor costs will be limited to those items in Article 109.04(b)(1) and (2), except the 35 percent and 10 percent additives will not be permitted.
- (b) Extended Project Overhead. For the duration of the delay, payment for extended project overhead will be paid as follows.
  - (1) Direct Jobsite and Offsite Overhead. Payment for documented direct jobsite overhead and documented direct offsite overhead, including onsite supervisory and administrative personnel, will be allowed according to the following table.

Original Contract Amount	Supervisory and Administrative Personnel
Up to \$5,000,000	One Project Superintendent
Over \$ 5,000,000 - up to \$25,000,000	One Project Manager, One Project Superintendent or Engineer, and One Clerk
Over \$25,000,000 - up to \$50,000,000	One Project Manager, One Project Superintendent, One Engineer, and

	One Clerk
Over \$50,000,000	One Project Manager, Two Project Superintendents, One Engineer, and One Clerk

(2) Home Office and Unabsorbed Overhead. Payment for home office and unabsorbed overhead will be calculated as 8 percent of the total delay cost.

(c) Extended Traffic Control. Traffic control required for an extended period of time due to the delay will be paid for according to Article 109.04.

When an extended traffic control adjustment is paid under this provision, an adjusted unit price as provided for in Article 701.20(a) for increase or decrease in the value of work by more than ten percent will not be paid.

Upon payment for a contract delay under this provision, the Contractor shall assign subrogation rights to the Department for the Department's efforts of recovery from any other party for monies paid by the Department as a result of any claim under this provision. The Contractor shall fully cooperate with the Department in its efforts to recover from another party any money paid to the Contractor for delay damages under this provision."

80384

## **SUBCONTRACTOR MOBILIZATION PAYMENTS (BDE)**

Effective: November 2, 2017

Revised: April 1, 2019

Replace the second paragraph of Article 109.12 of the Standard Specifications with the following:

“This mobilization payment shall be made at least seven days prior to the subcontractor starting work. The amount paid shall be at the following percentage of the amount of the subcontract reported on form BC 260A submitted for the approval of the subcontractor’s work.

Value of Subcontract Reported on Form BC 260A	Mobilization Percentage
Less than \$10,000	25%
\$10,000 to less than \$20,000	20%
\$20,000 to less than \$40,000	18%
\$40,000 to less than \$60,000	16%
\$60,000 to less than \$80,000	14%
\$80,000 to less than \$100,000	12%
\$100,000 to less than \$250,000	10%
\$250,000 to less than \$500,000	9%
\$500,000 to \$750,000	8%
Over \$750,000	7%”

80391

## **VEHICLE AND EQUIPMENT WARNING LIGHTS (BDE)**

Effective: November 1, 2021

Revised: November 1, 2022

Add the following paragraph after the first paragraph of Article 701.08 of the Standard Specifications:

“The Contractor shall equip all vehicles and equipment with high-intensity oscillating, rotating, or flashing, amber or amber-and-white, warning lights which are visible from all directions. In accordance with 625 ILCS 5/12-215, the lights may only be in operation while the vehicle or equipment is engaged in construction operations.”

80439

State of Illinois  
Department of Transportation  
Bureau of Local Roads and Streets

SPECIAL PROVISION  
FOR  
INSURANCE

Effective: February 1, 2007  
Revised: August 1, 2007

All references to Sections or Articles in this specification shall be construed to mean specific Section or Article of the Standard Specifications for Road and Bridge Construction, adopted by the Department of Transportation.

The Contractor shall name the following entities as additional insured under the Contractor's general liability insurance policy in accordance with Article 107.27:

---

---

---

---

---

---

---

---

The entities listed above and their officers, employees, and agents shall be indemnified and held harmless in accordance with Article 107.26.

State of Illinois  
Department of Transportation  
Bureau of Local Roads and Streets

SPECIAL PROVISION  
FOR  
EQUIPMENT RENTAL RATES

Effective: January 1, 2012

All references to Sections or Articles in this specification shall be construed to mean a specific Section or Article of the Standard Specifications for Road and Bridge Construction, adopted by the Department of Transportation.

Replace Article 109.04(b)(4) with the following:

- "(4) Equipment. For any machinery or special equipment (other than small tools) the use of which has been authorized by the Engineer, the Contractor will be paid according to the latest revision of "SCHEDULE OF AVERAGE ANNUAL EQUIPMENT OWNERSHIP EXPENSE" and latest index factor as issued by the Illinois Department of Transportation. The equipment should be of a type and size reasonably required to complete the extra work."

State of Illinois  
Department of Transportation  
Bureau of Local Roads and Streets

SPECIAL PROVISION  
FOR  
COARSE AGGREGATE FOR BITUMINOUS SURFACE TREATMENT

Effective: January 1, 2002  
Revised: January 1, 2007

All references to Sections or Articles in this special provision shall be construed to mean specific Section or Article of the Standard Specifications for Road and Bridge Construction, adopted by the Department of Transportation.

This work shall be performed according to Section 403 and the following:

1004.01 Materials. Add the following to the gradation tables in subparagraph (c) of Article 1004.01:

Coarse Aggregate Gradations					
Sieve Size					
Percent Passing					
Grad No.	12.5 mm ½ in.	9.5 mm 3/8 in.	4.75 mm #4	2.36 mm #8	1.18 mm #16
CA 20	100	92 ± 8	20 ± 10	5 ± 5	3 ± 3

1004.03 Coarse Aggregate for Hot-Mix Asphalt (HMA). Revise the first line of the table in subparagraph (c) of Article 1004.03 to read:

Use	Size/Application	Gradation No.
Class A-1, 2, & 3	3/8 in. (10 mm) Seal	CA 20 <sup>3/</sup>

Add the following note to the end of subparagraph (c) of Article 1004.03:

"3/ CA16 or CM16 produced under the AGCS Program with a master band may be used if it meets the gradation requirements specified for CA20 in Article 1004.01(c)"

Amend the Aggregate Gradation Control System (AGCS) Policy Memorandum to add the following:

"CA 20 shall be produced under the AGCS program. However, the gradation bands may not be adjusted."



State of Illinois  
DEPARTMENT OF TRANSPORTATION  
Bureau of Local Roads & Streets

SPECIAL PROVISION  
FOR  
EMULSIFIED ASPHALTS

Effective: January 1, 2007  
Revised: February 7, 2008

All references to Sections and Articles in this Special Provision shall be construed to mean specific Sections and Articles in the Standard Specifications for Road and Bridge Construction adopted by the Department of Transportation.

Replace the table after Note 2 in Article 403.02 with the following:

Type of Construction	Bituminous Materials Recommended for Weather Conditions Indicated	
	Warm [15 °C to 30 °C]* [(60 °F to 85 °F)]*	Hot [30 °C Plus]* [(85 °F Plus)]*
Prime	MC-30, PEP	MC-30, PEP
Cover Coat and Seal Coat	RS-2, CRS-2, RC-800, RC-3000, MC-800, MC-3000, SC-3000, HFE-90, HFE-150, HFE-300, HFRS-2, PEA**	RS-2, CRS-2, RC-800, RC-3000, MC-800, MC-3000, SC-3000, PG46-28, PG52-28, HFE-90, HFE-150, HFE-300, HFRS-2, PEA**

\* Temperature of the air in the shade at the time of application.

\*\* PEA is only allowed on roads with low traffic volumes

Replace the table after Note 2 in Article 406.02 with the following:

Type of Construction	Bituminous Materials Recommended
Prime (tack) on Brick, Concrete, or Bituminous Bases (Note 3)	SS-1, SS-1h, CSS-1, CSS-1h, HFE-90, RC-70
Prime on Aggregate Bases (Note 4)	MC-30, PEP
Mixture for Cracks, Joints, and Flangeways	PG58-22, PG64-22

Note 3. When emulsified asphalts are used, they shall be diluted with an equal volume of potable water. HFE emulsions shall be diluted by the manufacturer. The diluted material shall be thoroughly agitated within 24 hours of application and show no separation of water and emulsion. The diluted material shall not be returned to an approved emulsion storage tank.

Note 4. Preparation of the bituminous PEP shall be as specified in Article 403.05.

Replace the table in Article 1032.04 with the following:

Spraying Application Temperature Ranges		
Type and Grade of Bituminous Material	Temperature Ranges	
	°F min. - max.	°C min. - max.
PEP	60 - 130	15 - 55
PEA	140 - 190	60 - 88
MC-30	85 - 190	30 - 90
MC-70, RC-70, SC-70	120 - 225	50 - 105
MC-250, SC-250	165 - 270	75 - 130
MC-800, SC-800	200 - 305	95 - 150
MC-3000, SC-3000	230 - 345	110 - 175
PG46-28	275 - 385	135 - 195
PG52-28	285 - 395	140 - 200
RS-2, CRS-2	110 - 160	45 - 70
SS-1, SS-1h, CSS-1, CSS-1h	75 - 130	25 - 55
SS-1hP, CSS-1hP	75 - 130	25 - 55
HFE-90, HFE-150, HFE-300	150 - 180	65 - 80
HFP, CRSP, HFRS-2	150 - 180	65 - 80
E-2	85 - 190	30 - 90
E-3	120 - 225	50 - 105
E-4	165 - 270	75 - 130

Add subparagraph (g) to Article 1032.06:

- (g) Penetrating Emulsified Asphalt (PEA). The penetrating emulsified asphalt shall meet the following requirements when tested according to AASHTO T59:

Viscosity, Saybolt Fural @ 25°C (77°F),	sec:	20 - 500
Sieve Test, retained on 850 μm (No. 20) sieve, maximum,	%:	0.10
Storage Stability Test, 1 day, maximum,	%:	1
Float Test @ 60°C (140°F), minimum,	sec:	150
Stone Coating Test, 3 minutes,	:	Stone Coated Thoroughly
Particle Charge	:	Negative
pH, minimum	:	7.3
Distillation Test:		
Distillation to 260°C (500°F) Residue, minimum	%:	65
Oil Distillate by Volume, maximum	%:	3
Test on residue from distillation:		
Penetration @ 25°C (77°F), 100 g, 5 sec, minimum	dmm:	300

Replace the last sentence and table of Article 1032.06 with the following:

The different grades are, in general, used for the following.

Grade	Use
SS-1, SS-1h, CSS-1, CSS-1h, HFE 90, SS-1hP, CSS-1hP	Tack or fog seal
PEP	Bituminous surface treatment prime
RS-2, HFE 90, HFE 150, HFE 300, CRSP, HFP, CRS-2, HFRS-2, PEA	Bituminous surface treatment
CSS-1h Latex Modified	Microsurfacing

# BOYNTON ROAD DISTRICT TWP. 22N, R 3W, 3rd P.M. 23-01000-01-GM

	CA-16
	EAF CM-16

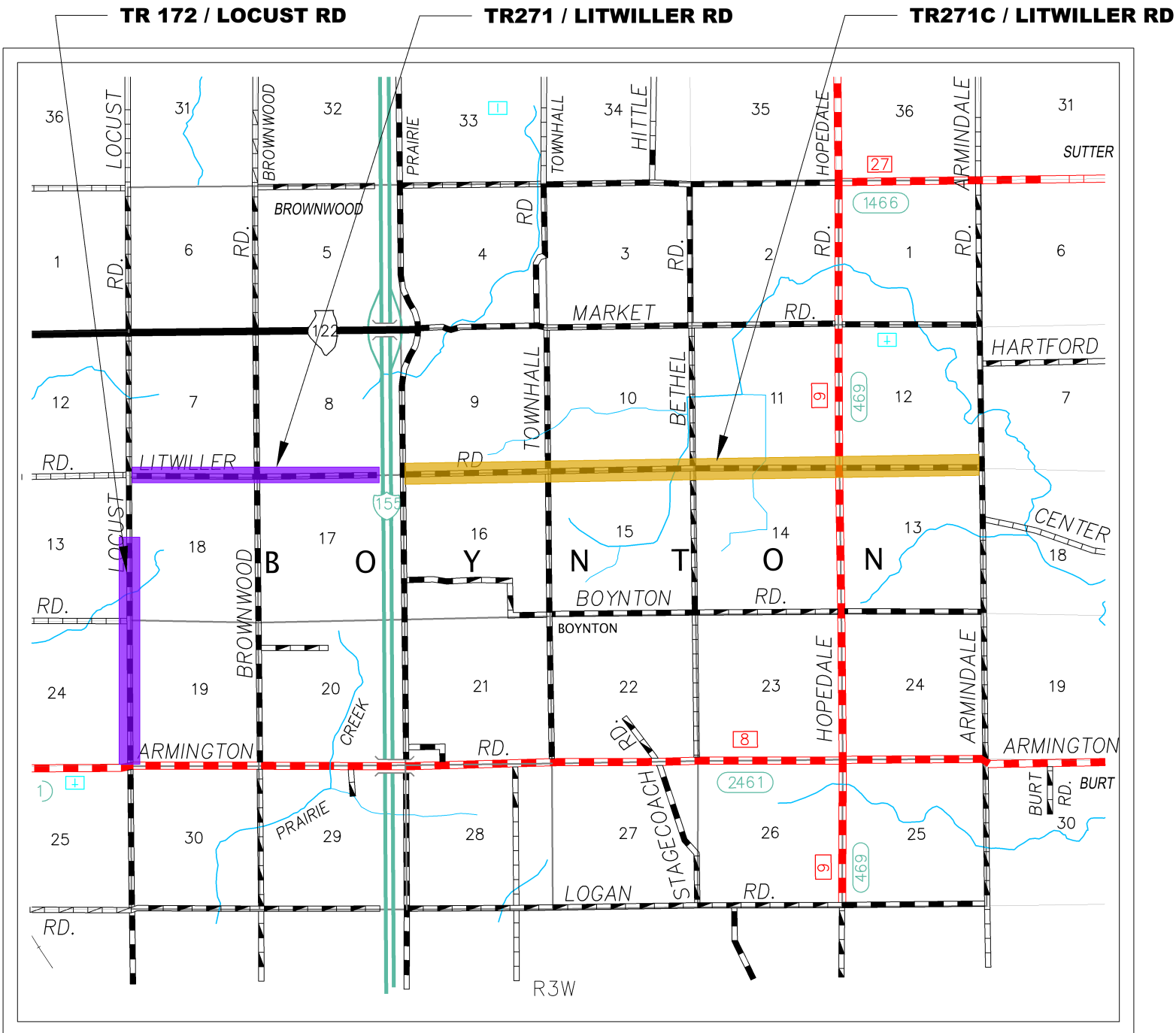



# DEER CREEK ROAD DISTRICT

## TWP. 25N, R 2W, 3rd P.M.

### 23-03000-01-GM

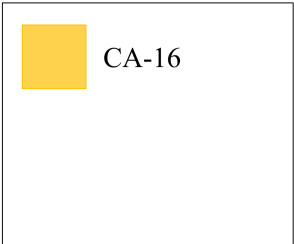

**TR 340 / ZIMMERMAN RD**

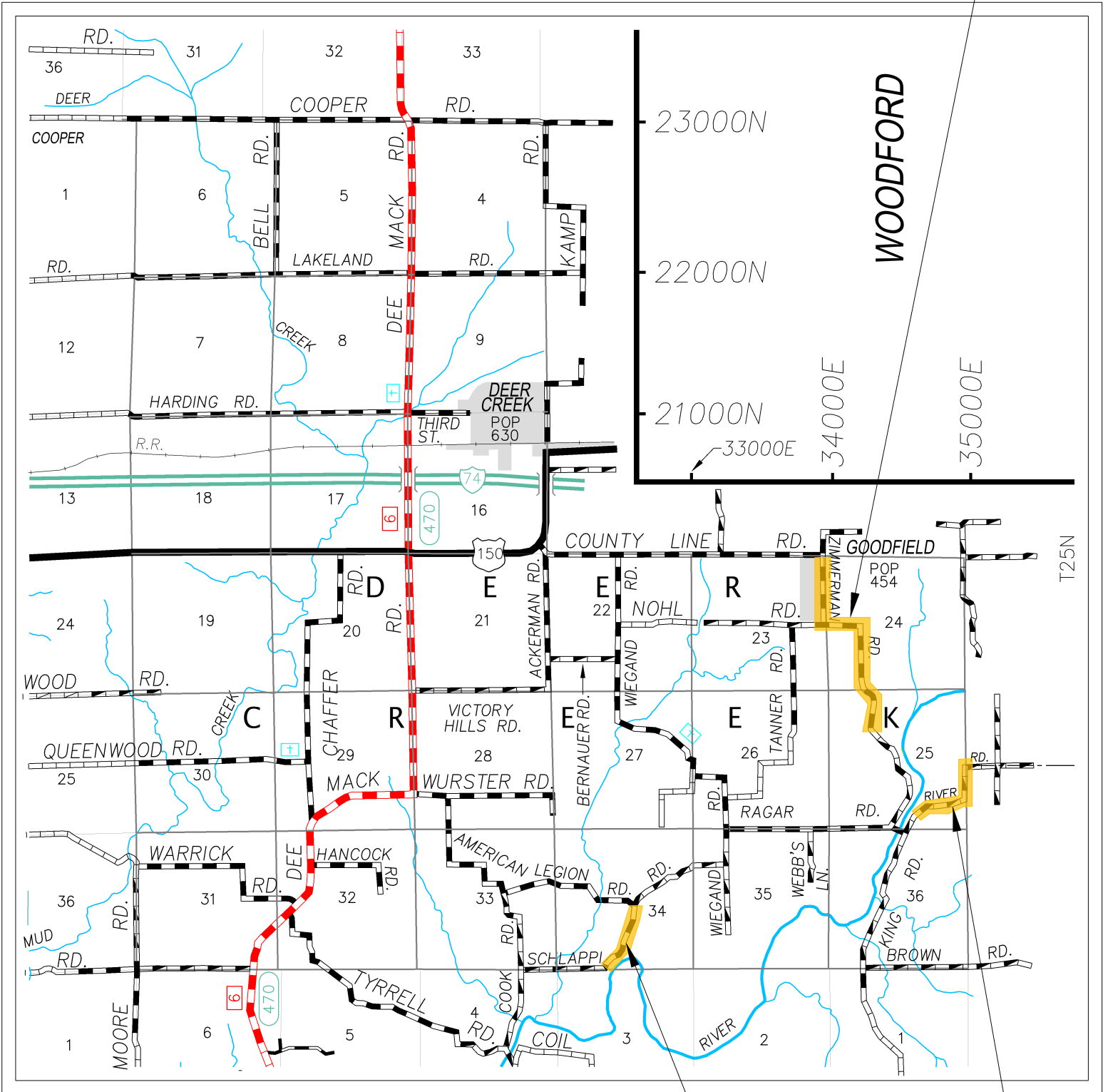

**TR 312 / SCHLAPPI RD**

**TR 338 / RIVER RD**

**Quantities**

<b><u>Route/Section</u></b>	<b><u>Length (ft)</u></b>	<b><u>Width (ft)</u></b>	<b><u>Area (SY)</u></b>	<b>PG52-28 <u>Gallons</u></b>	<b>CA-16 <u>Tons</u></b>
River Rd / TR338	3,950	22	9,656	2,993	116
Zimmerman RD / TR340*	9,700	20	21,745	6,741	261
Schlappi Rd / TR312*	2,535	18	5,149	1,596	62
	<b>16,185</b>		<b>36,550</b>	<b>11,331</b>	<b>439</b>

\*Denotes area includes intersection radii and/or cul de sac  
All Quantities are "Furnished and Replaced"

**Bituminous Materials (Seal Coat) PG52-28** **48 TON**  
Rate = 0.31 Gal/SY

**Seal Coat Aggregate (CA- 16)** **439 TON**  
Rate = 24#/SY

**Traffic Control & Protection, (Special)** **1 LUMP SUM**  
For entire project

# DELAVAN ROAD DISTRICT

## TWP. 22N, R 4W, 3rd P.M.

### 23-04000-01-GM



**BLACK TRAP ROCK**  
**CA-16**

**TR 134 / SPRINGFIELD RD**

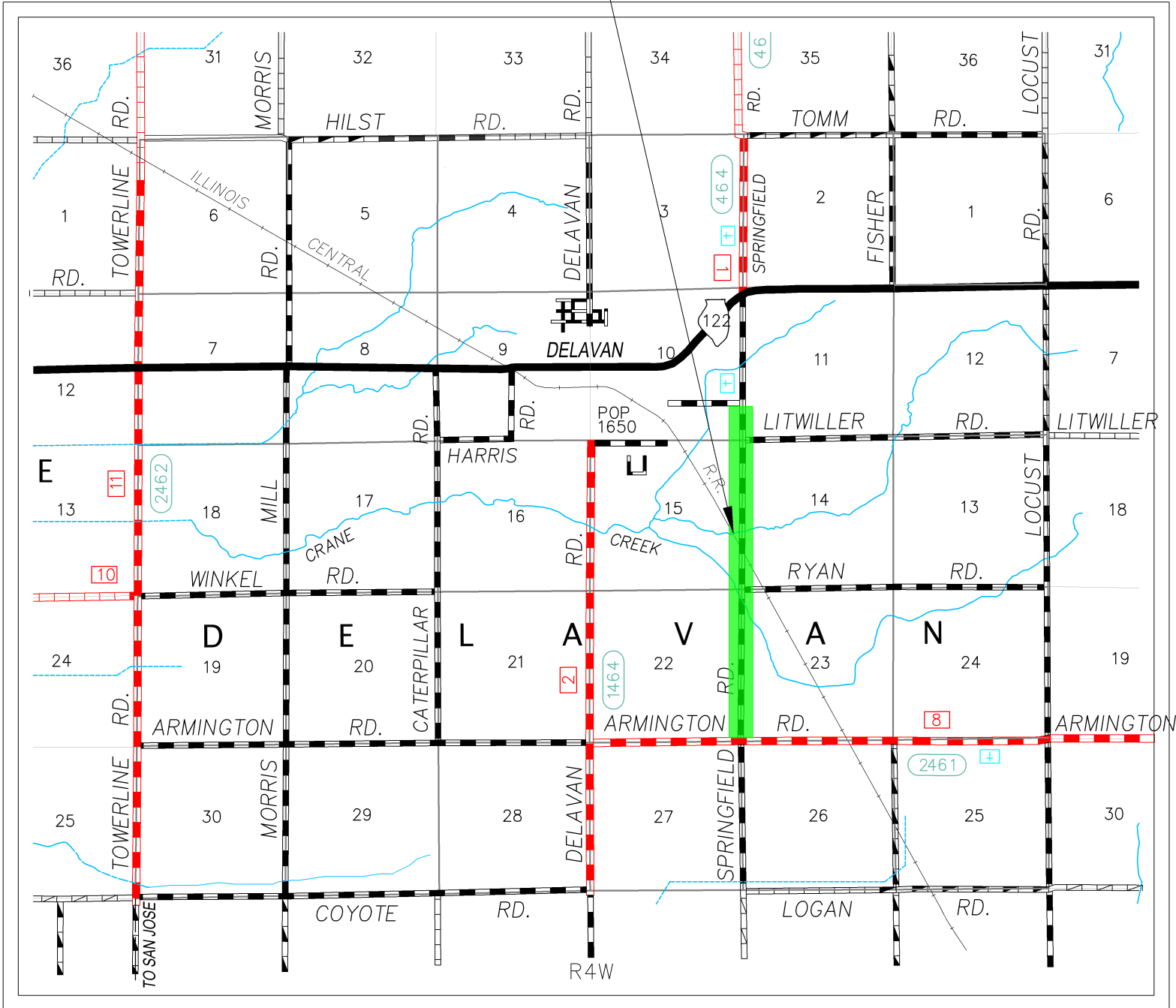



**QUANTITIES**

<b><u>Route/Section</u></b>	<b><u>Length (ft)</u></b>	<b><u>Width (ft)</u></b>	<b><u>Area (SY)</u></b>	<b><u>CRS-2P Gallons</u></b>	<b><u>Black Trap CA-16 Tons</u></b>
Springfield Rd / TR 134	11,800	19.50	25,567	11,249	345

All Quantities "Furnished & Applied"

**Polymerized Bituminous Materials (Seal Coat) CRS-2P** 48 TON  
Rate = 0.44 Gal/SY

**Seal Coat Aggregate (Black Trap Rock CA-16)** 345 TON  
Rate = 27 #/SY

**Traffic Control and Protection (Special)** 1 LUMP SUM  
For entire Project

# DILLON ROAD DISTRICT

## TWP. 23N, R 4W, 3rd. P.M.

### 23-05000-01-GM

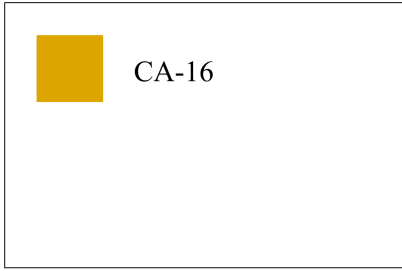

TR 213A / CEDAR BLUFF RD

TR 150A / ROBINS LN

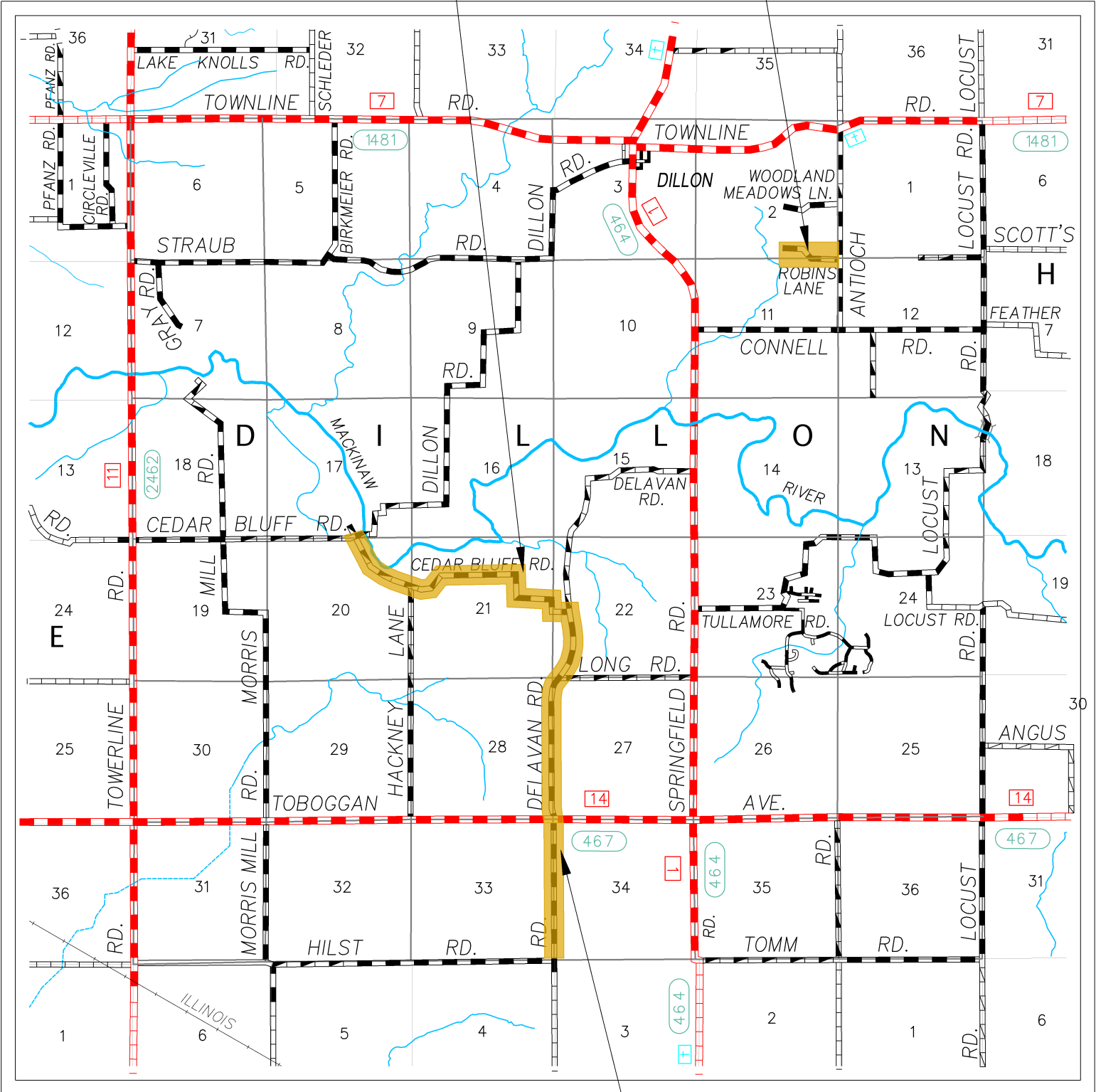

TR 130 / DELAVAN RD

**Quantities**

<b><u>Route/Section</u></b>	<b><u>Length (ft)</u></b>	<b><u>Width (ft)</u></b>	<b><u>Area (SY)</u></b>	<b>PG52-28 <u>Gallons</u></b>	<b>CA-16 <u>Tons</u></b>
Robins Ln / TR 150A*	1,550	17	3,536	1,096	42
Delevan Rd / TR130	13,340	18	27,907	8,651	335
Cedar Bluff Rd / TR 213A*	10,300	18	21,149	6,556	254
	<b>25,190</b>		<b>52,592</b>	<b>16,304</b>	<b>631</b>

\*Denotes area includes intersection radii and/or cul de sac  
All Quantities are "Furnished and Replaced"

**Bituminous Materials (Seal Coat) PG52-28** **70 TON**  
Rate = 0.31 Gal/SY

**Seal Coat Aggregate (CA- 16)** **631 TON**  
Rate = 24#/SY

**Traffic Control & Protection, (Special)** **1 LUMP SUM**  
For entire project

# ELM GROVE ROAD DISTRICT

## TWP. 24N, R 4W, 3rd. P.M.

### 23-06000-01-GM

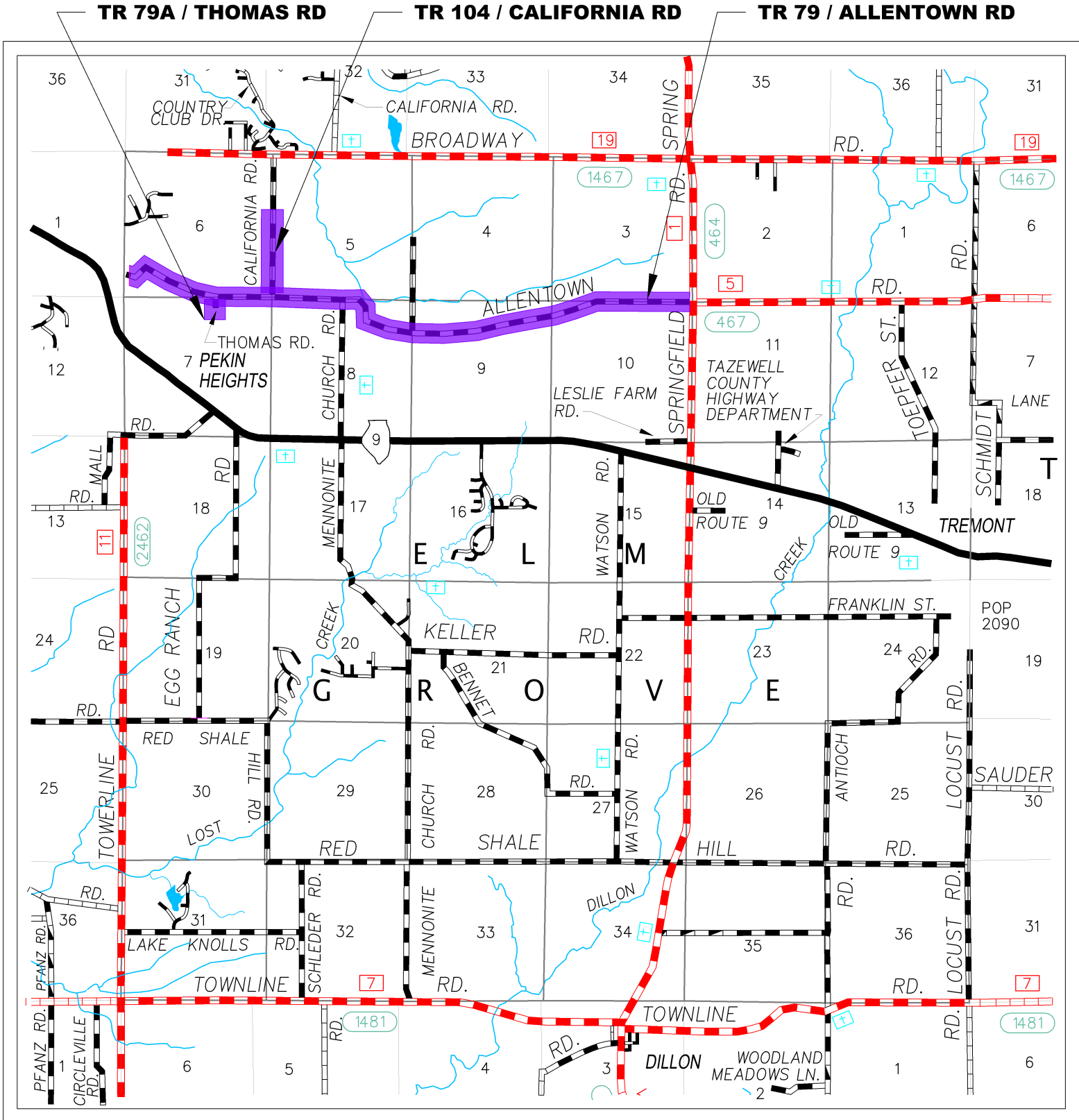
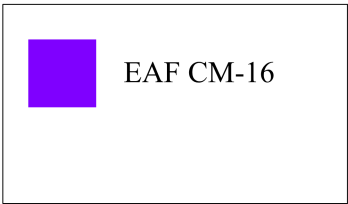

**QUANTITIES**

<b><u>Route/Section</u></b>	<b><u>Length</u></b>	<b><u>Width</u></b>	<b><u>Seal Coat Area</u></b>
Allentown Rd. / TR 79	4,767 LF	20'	10,593 SY
Allentown Rd. / TR 79	220 LF	28'	684 SY
Allentown Rd. / TR 79	640 LF	25'	1,807 SY *
Allentown Rd. / TR 79	13,722 LF	20.5'	31,256 SY
Allentown Rd. / TR 79	1,353 LF	24.5'	3,705 SY *
Thomas Rd. / TR 79A	260 LF	17'	494 SY *
California Rd. / TR 104	<u>2,740 LF</u>	18'	<u>5,495 SY *</u>
<b>TOTALS:</b>	<b>23,702 LF</b>		<b>54,034 SY</b>

All Quantities "Furnished & Applied"

\* Denotes area includes intersection radii

**Polymerized Bituminous Materials (Seal Coat) CRS-2P:**

$$54,034 \text{ SY} \times 0.55 \text{ GAL/SY} = 29,719 \text{ GALLON}$$

$$29,719 \text{ GALLON} \times 8.45/2000\# = \underline{126 \text{ TON}}$$

**Seal Coat Aggregate (EAF CM-16):**

$$54,034 \text{ SY} \times 30\#/SY / 2000\# = \underline{811 \text{ TON}}$$

**Traffic Control and Protection (Special):**

$$\text{For entire project} = \underline{1 \text{ LUMP SUM}}$$

# FONDULAC ROAD DISTRICT

## TWP. 26N, R 4W, 3rd P.M.

### 23-07000-01-GM

 BLACK TRAP ROCK CA-16

PEORIA COUNTY

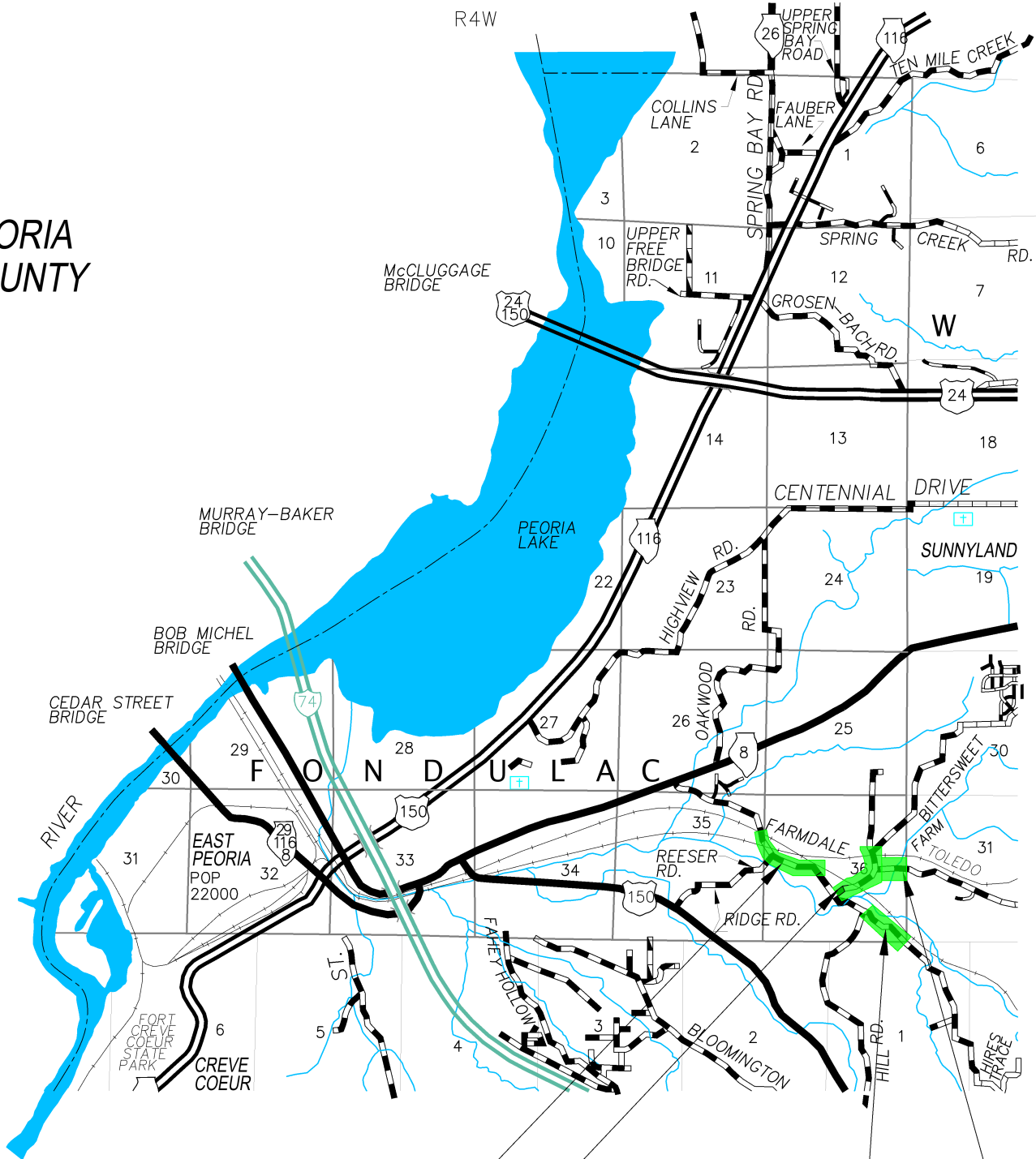

FAU 6775 / FARMDALE RD

TR 156 / VETERANS RD

FAU 6775 / BITTERSWEET RD

TR 23 / FARMDALE RD

**Quantities**

<b><u>Route/Section</u></b>	<b><u>Length (ft)</u></b>	<b><u>Width (ft)</u></b>	<b><u>Area (SY)</u></b>	<b>Trap Rock</b>	
				<b><u>CRS-2P Gallons</u></b>	<b><u>CA-16 Tons</u></b>
Farmdale Rd / FAU 6775*	2,700	22.5	7,202	3,169	97
Farmdale Rd / TR 23*	1,346	22	3,884	1,709	52
Bittersweet Rd / FAU 6775	1,135	22	2,774	1,221	37
Veterans Rd / TR 156	<u>2,300</u>	21	<u>5,367</u>	<u>2,361</u>	72
	<b>7,481</b>		<b>19,227</b>	<b>8,460</b>	<b>258</b>

\*Denotes area includes intersection radii and/or cul de sac  
All Quantities are "Furnished and Applied"

**Polymerized Bituminous Materials (Seal Coat) CRS-2P** **36 TON**  
Rate = 0.44 Gal/SY

**Seal Coat Aggregate (Black Trap Rock CA- 16)** **258 TON**  
Rate = 27#/SY

**Traffic Control & Protection, (Special)** **1 LUMP SUM**  
For entire project

# HITTLE ROAD DISTRICT

## TWP. 22N, R 2W, 3rd P.M.

### 23-09000-01-GM

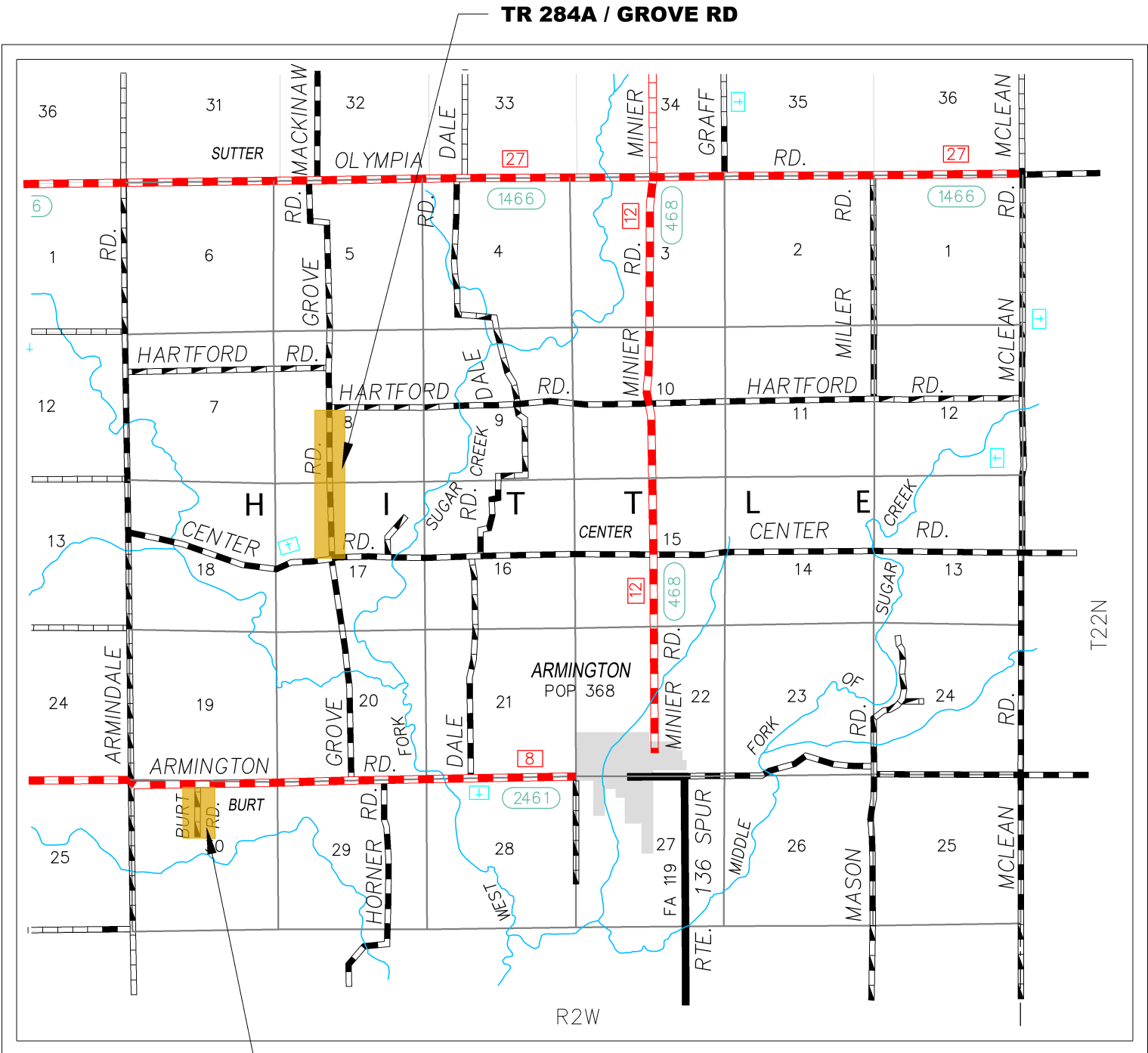
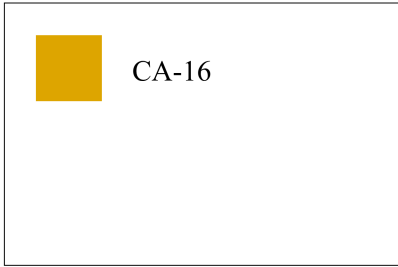

TR 272 / BURT RD



**Quantities**

<b><u>Route/Section</u></b>	<b><u>Length (ft)</u></b>	<b><u>Width (ft)</u></b>	<b><u>Area (SY)</u></b>	<b>CRS-2P <u>Gallons</u></b>	<b>CA-16 <u>Tons</u></b>
Burt Rd / TR 272	1,966	16	3,495	1,468	47
Grove Rd / TR284A *	5,319	18	11,745	4,933	159
	<b>7,285</b>		<b>15,240</b>	<b>6,401</b>	<b>206</b>

\*Denotes area includes intersection radii and/or cul de sac  
All Quantities are "Furnished and Applied"

**Polymerized Bituminous Materials (Seal Coat) CRS-2P** **27 TON**  
Rate = 0.42 Gal/SY

**Seal Coat Aggregate (CA- 16)** **206 TON**  
Rate = 27#/SY

**Traffic Control & Protection, (Special)** **1 LUMP SUM**  
For entire project

# LITTLE MACKINAW ROAD DISTRICT

## TWP. 23N, R 2W, 3rd P.M.

### 23-11000-01-GM

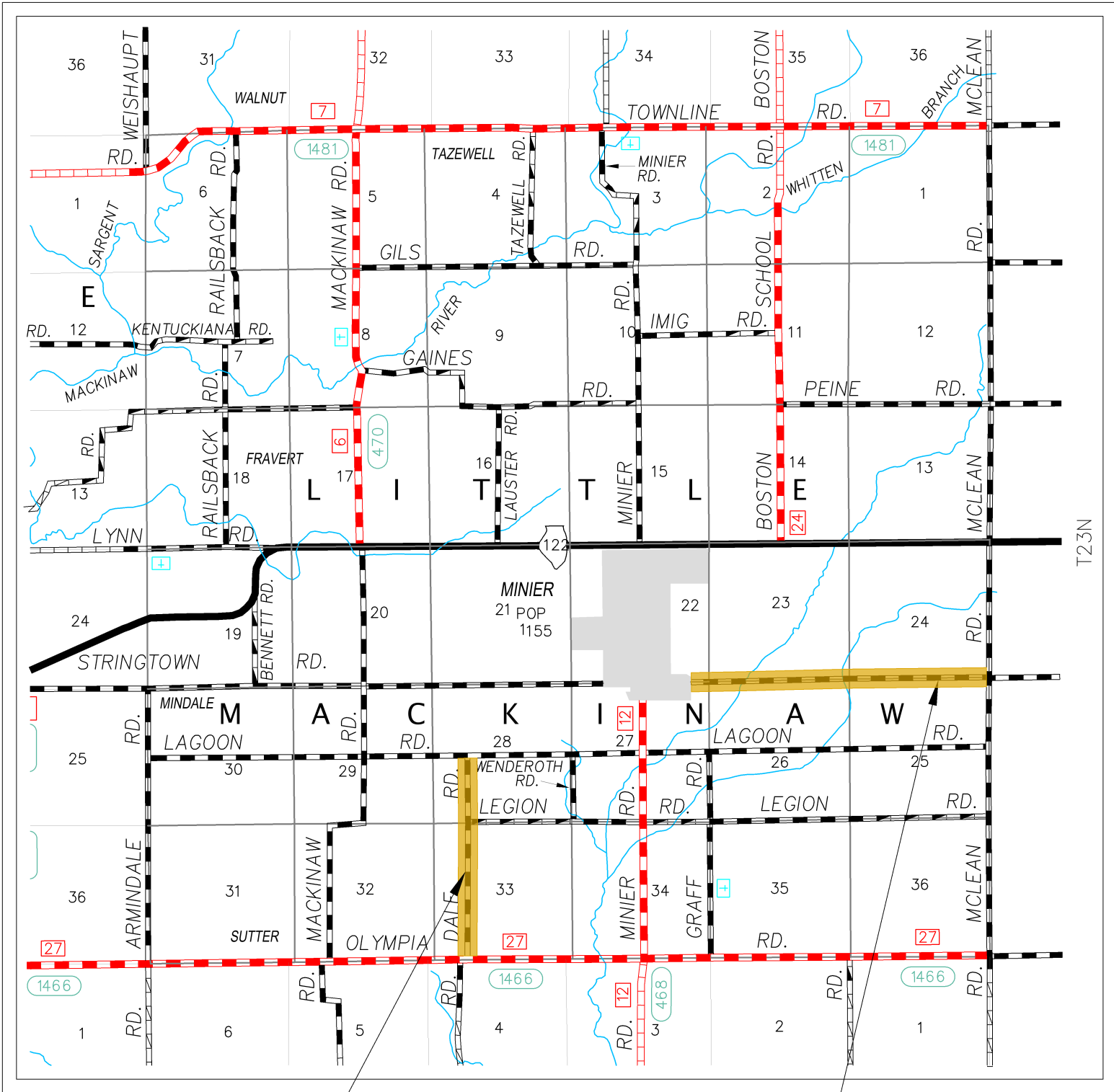
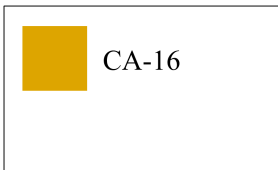

**TR 296 / DALE RD**

**TR 229A / STRINGTOWN RD**

**Quantities**

<b><u>Route/Section</u></b>	<b><u>Length (ft)</u></b>	<b><u>Width (ft)</u></b>	<b><u>Area (SY)</u></b>	<b>PG52-28 <u>Gallons</u></b>	<b>CA-16 <u>Tons</u></b>
Stringtown Rd / TR 229A	11,397	21	26,593	8,244	319
Dale Rd / TR 296*	7,906	17.5	15,427	4,782	185
	<b>19,303</b>		<b>42,020</b>	<b>13,026</b>	<b>504</b>

\*Denotes area includes intersection radii and/or cul de sac  
 All Quantities are "Furnished and Applied"

**Bituminous Materials (Seal Coat) PG52-28** 56 TON  
 Rate = 0.31 Gal/SY

**Seal Coat Aggregate (CA- 16)** 504 TON  
 Rate = 24#/SY

**Traffic Control & Protection, (Special)** 1 LUMP SUM  
 For entire project

# MALONE ROAD DISTRICT

## TWP. 22N, R 5W, 3rd P.M.

### 23-13000-01-GM

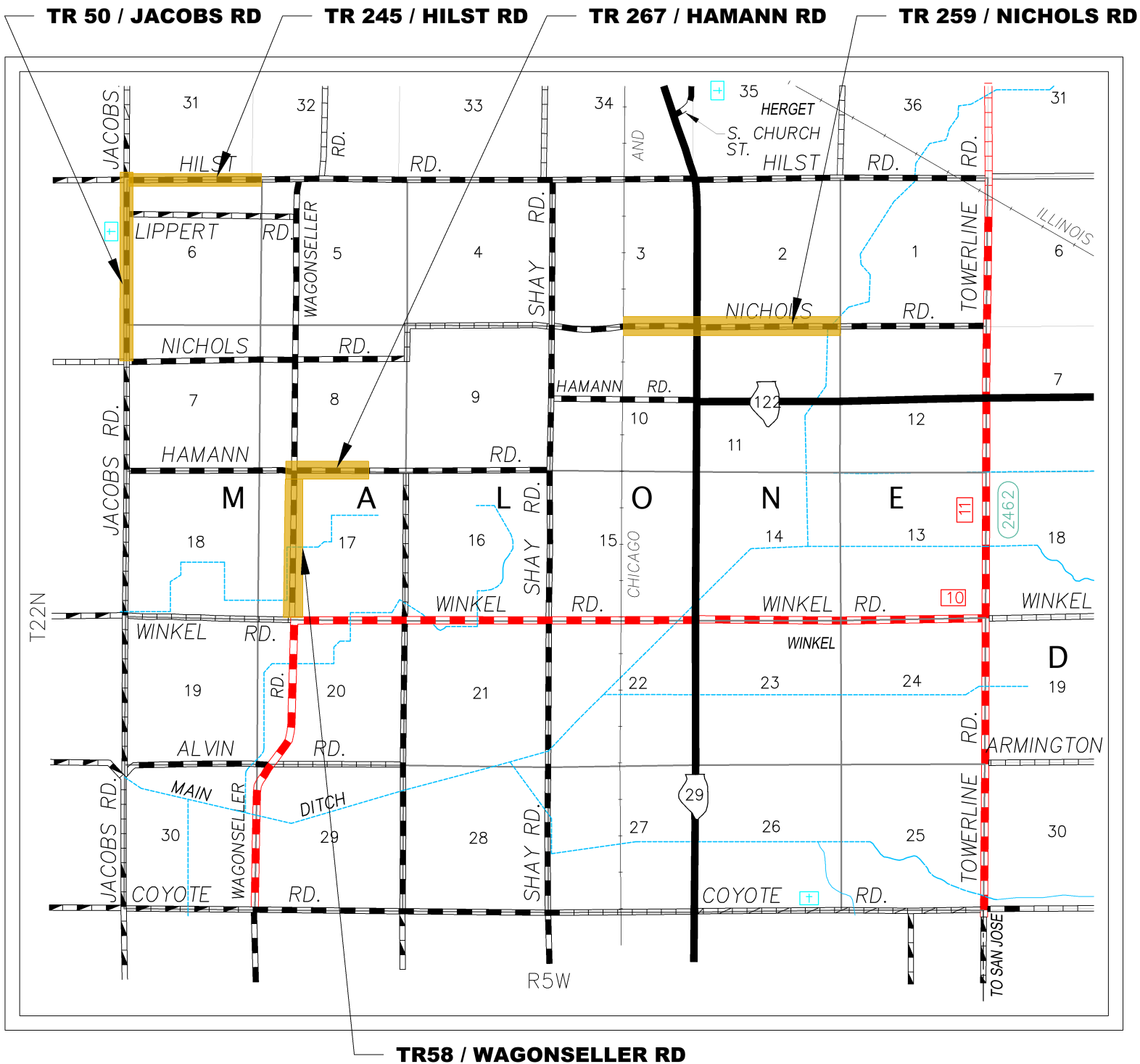
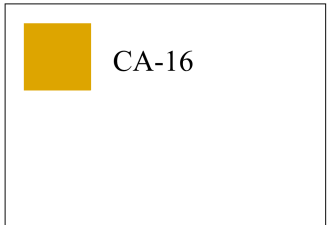

**Quantities**

<b><u>Route/Section</u></b>	<b><u>Length (ft)</u></b>	<b><u>Width (ft)</u></b>	<b><u>Area (SY)</u></b>	<b>PG52-28 <u>Gallons</u></b>	<b>CA-16 <u>Tons</u></b>
Wagonseller Rd / TR 58	5,275	20	11,722	3,634	141
Hamann Rd / TR 267*	1,950	15	3,377	1,047	41
Nichols Rd / TR 259*	7,269	18	14,598	4,525	175
Hilst Rd / TR 245*	4,930	18	9,935	3,080	119
Jacobs Rd / TR 50*	<u>6,625</u>	18	<u>13,417</u>	<u>4,159</u>	<u>161</u>
	<b>26,049</b>		<b>53,049</b>	<b>16,445</b>	<b>637</b>

\*Denotes area includes intersection radii and/or cul de sac  
All Quantities are "Furnished and Replaced"

**Bituminous Materials (Seal Coat) PG52-28** **70** **TON**  
Rate = 0.31 Gal/SY

**Seal Coat Aggregate (CA- 16)** **637** **TON**  
Rate = 24#/SY

**Traffic Control & Protection, (Special)** **1 LUMP SUM**  
For entire project

# SAND PRAIRIE ROAD DISTRICT

## TWP. 23N, R 5W, 3rd P.M.

### 23-16000-01-GM

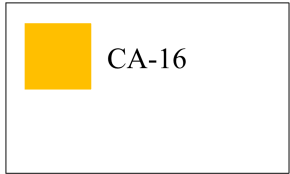

**TR 167 / CHRISTMAS TREE RD**

**TR 56 / PRAIRIE RD**

**TR 68 / DEPERT RD**

**TR 88A / PFANZ RD**

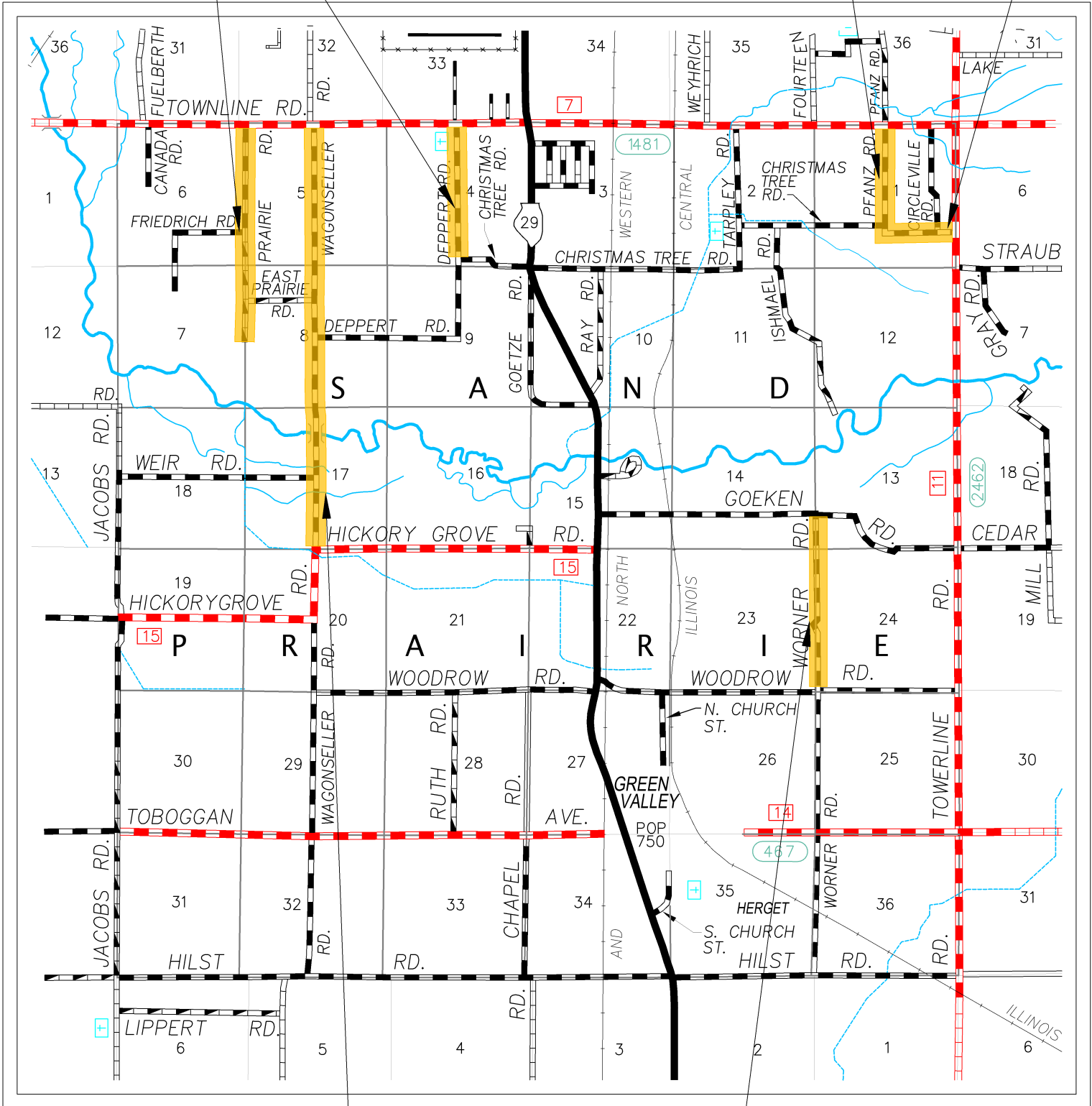

**TR 62A / WAGGONSELLER RD**

**TR 84 / WORNOR RD**

**Quantities**

<b><u>Route/Section</u></b>	<b><u>Length (ft)</u></b>	<b><u>Width (ft)</u></b>	<b><u>Area (SY)</u></b>	<b><u>PG52-28 Gallons</u></b>	<b><u>CA-16 Tons</u></b>	<b><u>CA-14 Tons</u></b>
Prairie Rd / TR 56*	8,005	17	15,250	4,728	183	
Wagonseller Rd / TR62A	15,470	20	34,378	10,657	413	
Wagonseller Rd / TR62A (edge)	3,430	3	1,143	354		15
Pfanz Rd / TR 88A	2,710	18	5,420	1,680	65	
Christmas Tree Rd / TR 167	3,840	18	7,680	2,381	92	
Worner Rd / TR 84*	6,642	18	13,484	4,180	162	
Deppert Rd / TR 68	4,263	18	8,526	2,643	102	
	<b>44,360</b>		<b>85,881</b>	<b>26,623</b>	<b>1,017</b>	<b>15</b>

\*Denotes area includes intersection radii and/or cul de sac  
All Quantities are "Furnished and Applied"

**Bituminous Materials (Cover and Seal Coats) PG52-28** **114** **TON**  
Rate = 0.31 Gal/SY (CA-16)  
Rate = 0.33 Gal/SY (CA-14)

**Seal Coat Aggregate (CA- 16)** **1,017** **TON**  
Rate = 24#/SY

**Cover Coat Aggregate (CA- 14)** **15** **TON**  
Rate = 26#/SY

**Traffic Control & Protection, (Special)** **1 LUMP SUM**  
For entire project

SPRING LAKE ROAD DISTRICT  
 TWP. 24N, R 6 & 7W, 3rd P.M.  
 TWP. 23N, R 6 & 7W, 3rd P.M.  
 23-17000-01-GM

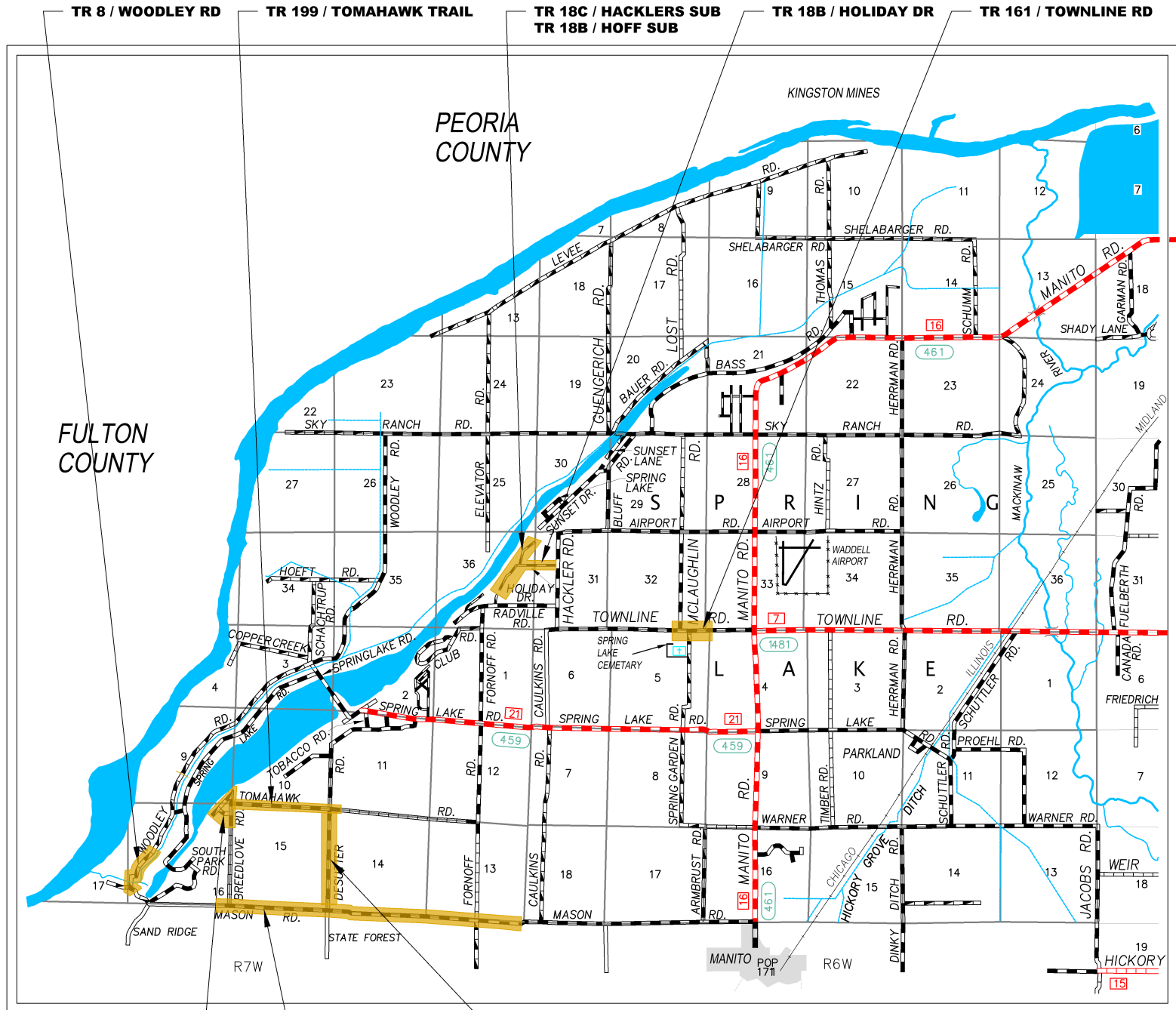
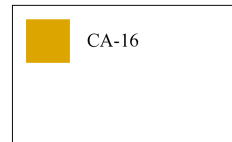

TR 199 / BREEDLOVE RD  
 TR 199A / ARROWHEAD RD

TR 1 / MASON RD

Page 39  
 TR 6 / DESUTTER RD



**Quantities**

<b><u>Route/Section</u></b>	<b><u>Length (ft)</u></b>	<b><u>Width (ft)</u></b>	<b><u>Area (SY)</u></b>	<b><u>PG52-28 Gallons</u></b>	<b><u>CA-16 Tons</u></b>
Holiday Dr / TR18B*	2,082	20.5	4,920	1,525	59
Hacklers Sub / TR 18C*	1,730	15	3,061	949	37
Hoff Sub / TR 18B*	1,732	15	3,156	978	38
Mason Rd / TR 1	16,115	21.5	38,497	11,934	462
Woodley Rd / TR 8*	2,100	16	3,826	1,186	46
Desutter Rd / TR 6*	5,530	20	12,375	3,836	149
Tomahawk Trail / TR199*	7,040	17	14,261	4,421	171
Arrowhead Rd / TR 199A*	425	15	918	285	11
Breedlove Rd / TR 199*	1,350	18.5	3,176	985	38
Townline Rd / TR161	<u>2,420</u>	20	<u>5,378</u>	<u>1,667</u>	<u>65</u>
	<b>40,524</b>		<b>89,568</b>	<b>27,766</b>	<b>1,075</b>

\*Denotes area includes intersection radii and/or cul de sac  
All Quantities are "Furnished and Replaced"

**Bituminous Materials (Seal Coat) PG52-28** **119 TON**  
Rate = 0.31 Gal/SY

**Seal Coat Aggregate (CA- 16)** **1,075 TON**  
Rate = 24#/SY

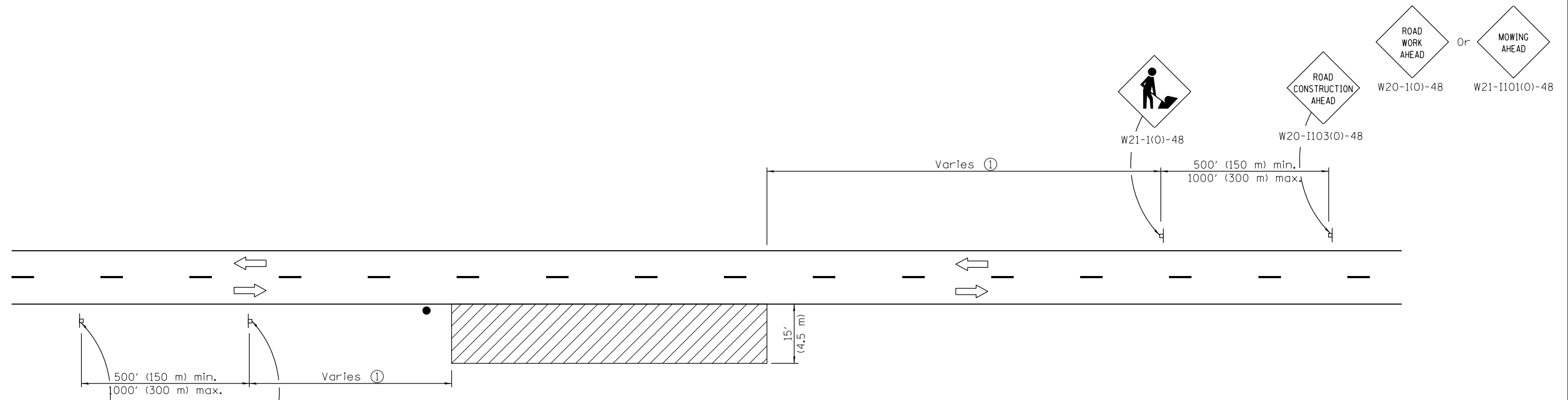

**Traffic Control & Protection, (Special)** **1 LUMP SUM**  
For entire project

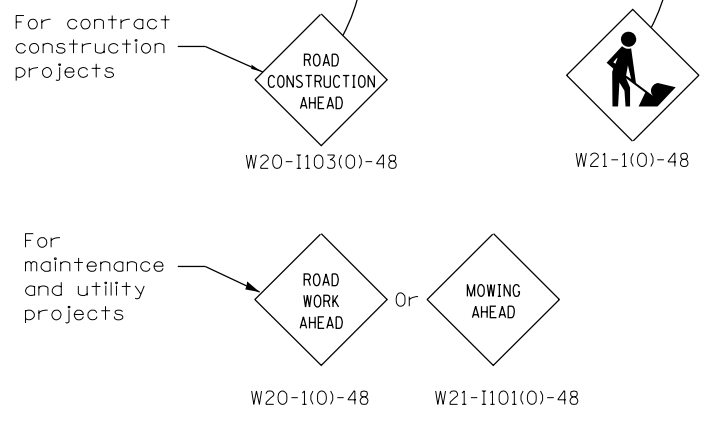

**TYPICAL APPLICATIONS**  
Shoulder work  
Utility operations

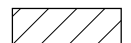

**SYMBOLS**

-  Work area
-  Sign
-  Flagger with traffic control sign when required

① Minimum distance is 200' (60 m). Maximum distance to be determined by the Engineer but should not exceed 1/2 the length required for one normal working day's operation, or 4 miles (6.4 km) whichever is less.

**GENERAL NOTES**

This Standard is used where at any time, any vehicle, equipment, workers or their activities require an intermittent or continuous moving operation on the shoulder, where the average speed is 1 mph (2 km/h) or less.

When the work operation does not exceed 60 minutes, traffic control may be according to Standard 701301.

All dimensions are in inches (millimeters) unless otherwise shown.

DATE	REVISIONS
1-1-14	Revised workers sign number to agree with current MUTCD.
1-1-13	Omitted text 'WORKERS' sign.

**OFF-RD MOVING OPERATIONS,  
2L, 2W, DAY ONLY**

---

**STANDARD 701011-04**

Illinois Department of Transportation

APPROVED January 1, 2014  
*[Signature]*  
ENGINEER OF SAFETY ENGINEERING

APPROVED January 1, 2014  
*[Signature]*  
ENGINEER OF DESIGN AND ENVIRONMENT

ISSUED 1-1-97

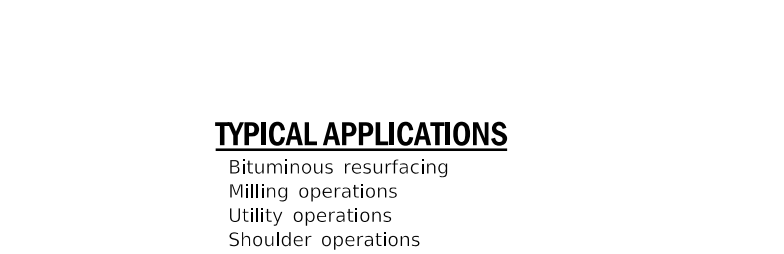
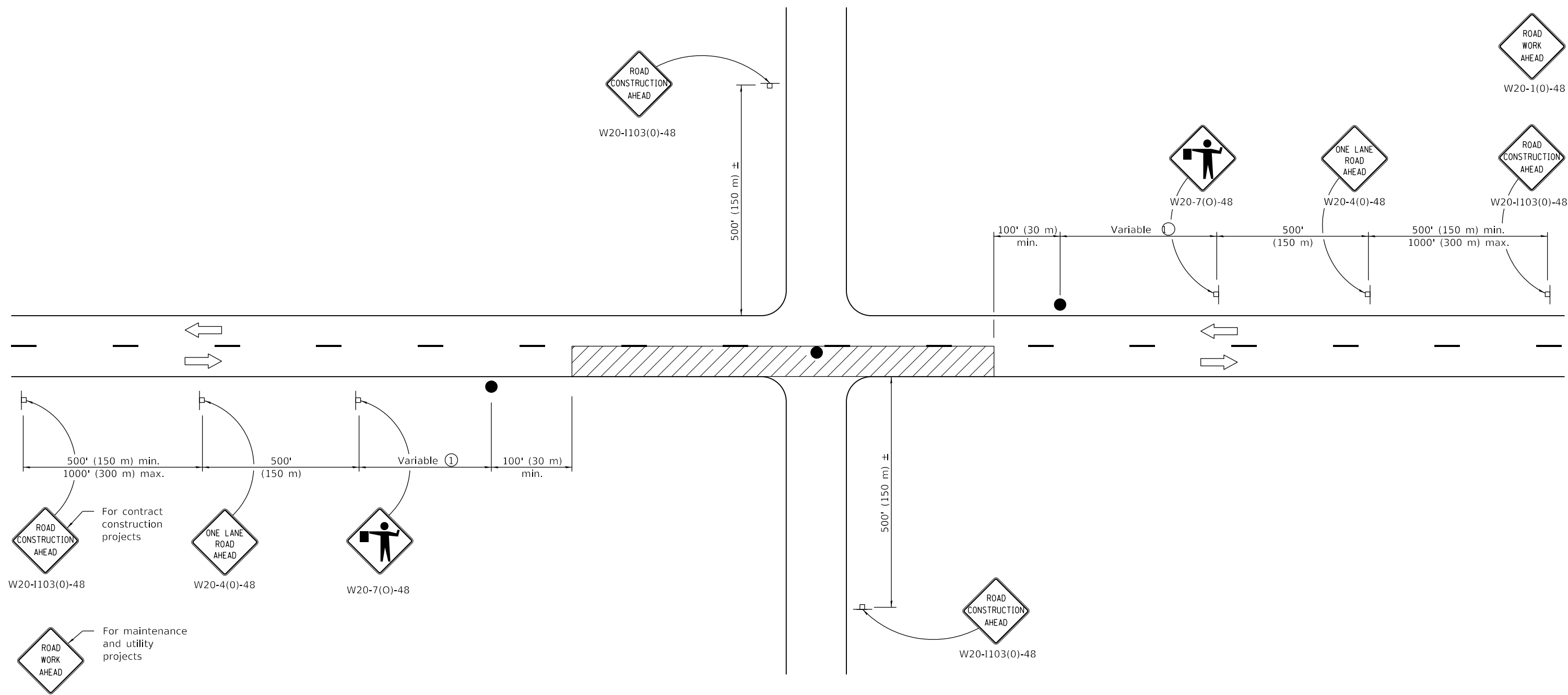

**TYPICAL APPLICATIONS**

- Bituminous resurfacing
- Milling operations
- Utility operations
- Shoulder operations

**SYMBOLS**

- Work area
- Sign on portable or permanent support
- Flagger with traffic control sign

① Minimum distance is 200' (60 m). Maximum distance to be determined by the Engineer but should not exceed ½ the length required for one normal working day's operation or 2 miles (3200 m), whichever is less.

**GENERAL NOTES**

This Standard is used where at any time, any vehicle, equipment, workers or their activities require an intermittent or continuous moving operation on the pavement where the average speed of movement is greater than ½ mph (1 km/h) and less than 4 mph (6 km/h).

When the operation does not exceed 60 minutes, traffic control may be according to Standard 701301.

All dimensions are in inches (millimeters) unless otherwise shown.

DATE	REVISIONS
1-1-18	Revised lower speed limit for operation to ½ mph.
1-1-11	Revised flagger sign.

**LANE CLOSURE, 2L, 2W, SLOW MOVING OPERATIONS DAY ONLY, FOR SPEEDS ≥ 45 MPH**

**STANDARD 701306-04**

Illinois Department of Transportation

PASSED January 1, 2018  
*Paul L. ...*  
 ENGINEER OF SAFETY PROG. AND ENGINEERING

APPROVED January 1, 2018  
*Walter M. ...*  
 ENGINEER OF DESIGN AND ENVIRONMENT

ISSUED 1-1-97

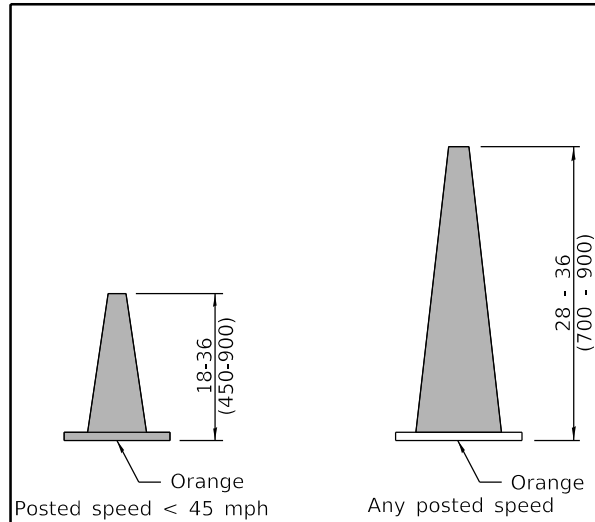

**DAYTIME USE**

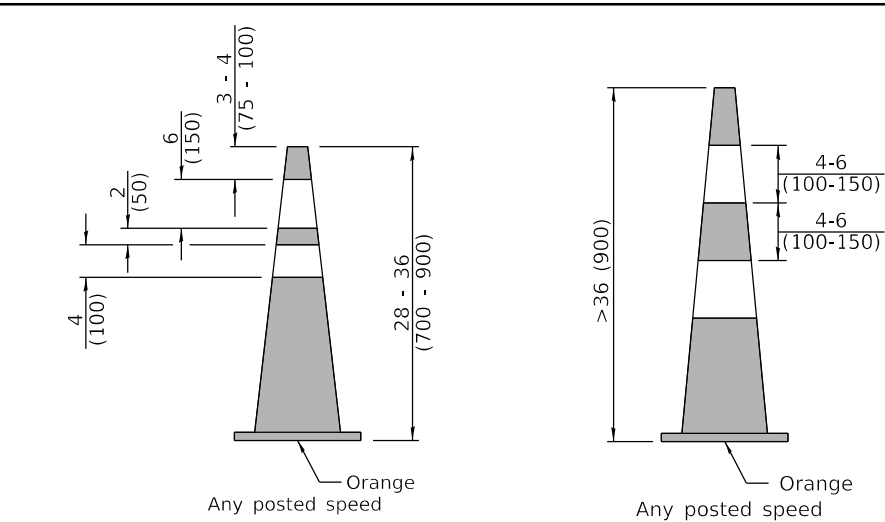

**DAY OR NIGHTTIME USE**

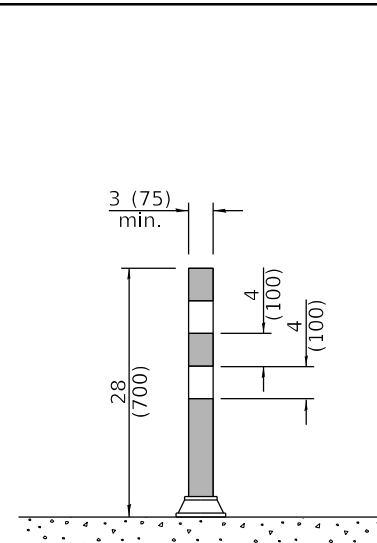

**TUBULAR MARKER**

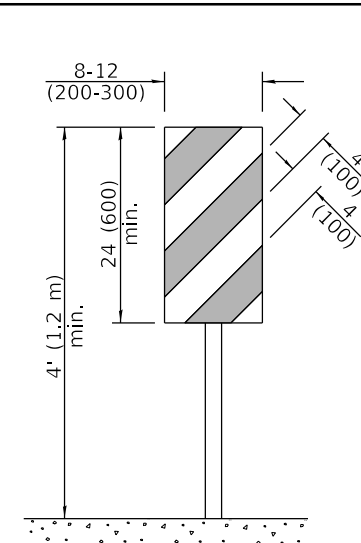

**VERTICAL PANEL  
POST MOUNTED**

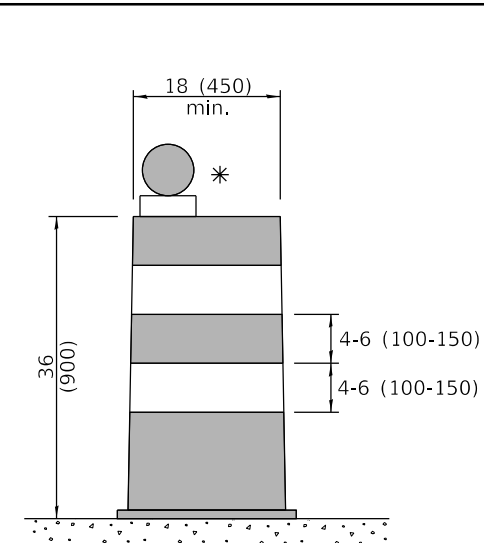

**DRUM**

**CONES**

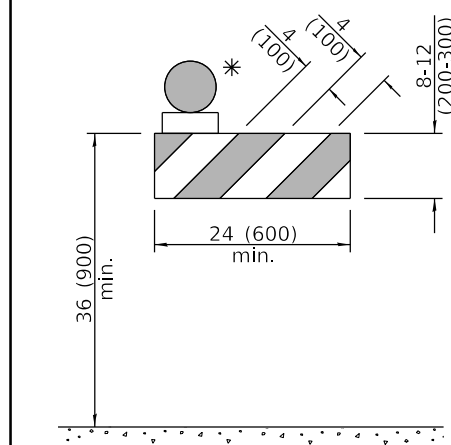

**TYPE I BARRICADE**

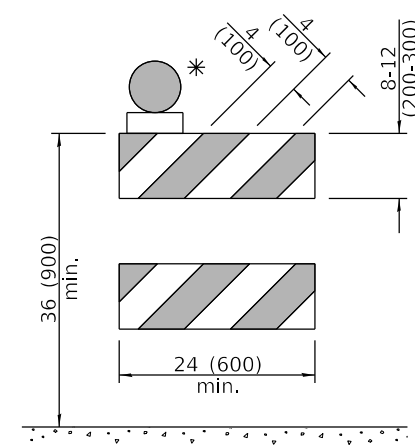

**TYPE II BARRICADE**

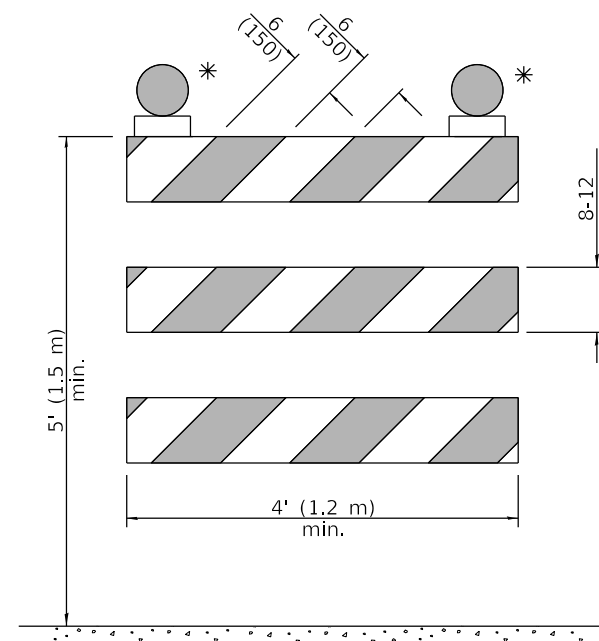

**TYPE III BARRICADE**

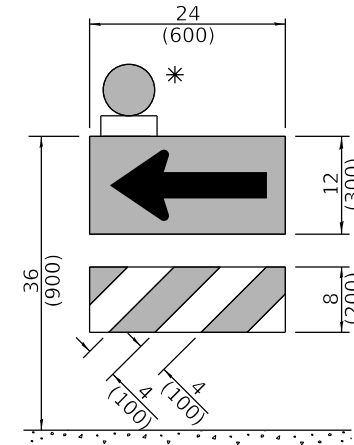

**DIRECTION INDICATOR  
BARRICADE**

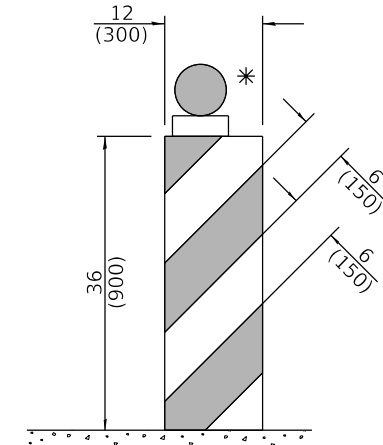

**VERTICAL BARRICADE**

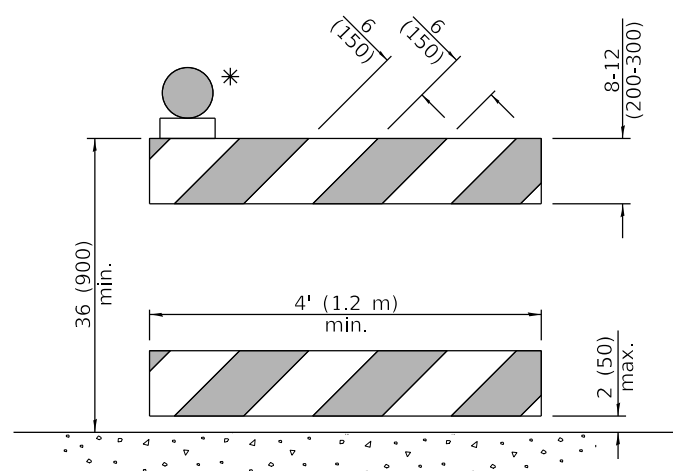

**DETECTABLE PEDESTRIAN  
CHANNELIZING BARRICADE**

\* Warning lights (if required)

**GENERAL NOTES**

All heights shown shall be measured above the pavement surface.

All dimensions are in inches (millimeters) unless otherwise shown.

Illinois Department of Transportation

APPROVED January 1, 2019  
  
 ENGINEER OF SAFETY PROG. AND ENGINEERING

APPROVED January 1, 2019  
  
 ENGINEER OF DESIGN AND ENVIRONMENT

ISSUED  
 ET-1-1 08/SS1

DATE	REVISIONS
1-1-19	Revised cone usage and added cones >36" (900 mm) height.
1-1-18	Revised END WORK ZONE SPEED LIMIT sign from orange to white background.

**TRAFFIC CONTROL DEVICES**

(Sheet 1 of 3)

**STANDARD 701901-08**

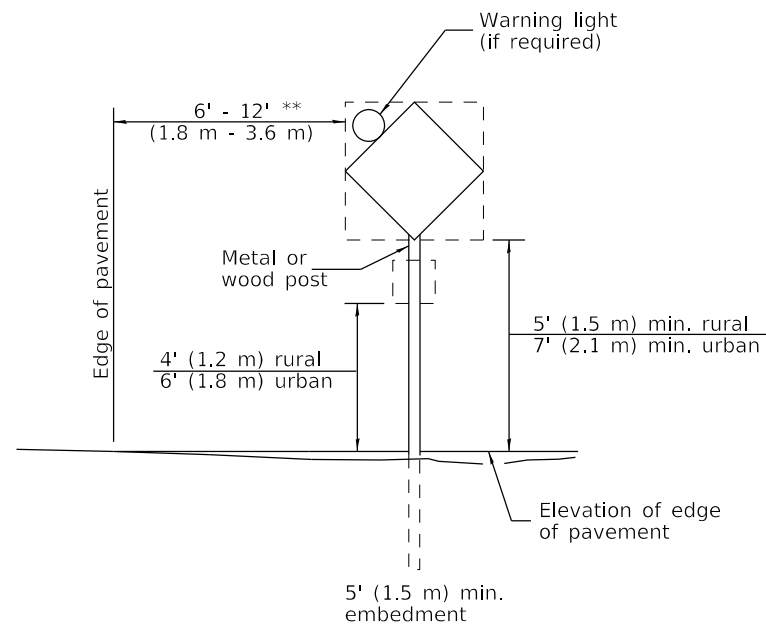

**POST MOUNTED SIGNS**

\*\* When curb or paved shoulder are present this dimension shall be 24 (600) to the face of curb or 6' (1.8 m) to the outside edge of the paved shoulder.

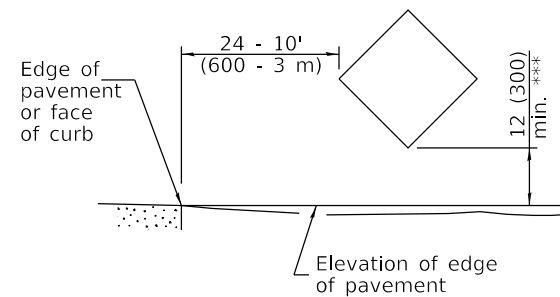

**SIGNS ON TEMPORARY SUPPORTS**

\*\*\* When work operations exceed four days, this dimension shall be 5' (1.5 m) min. If located behind other devices, the height shall be sufficient to be seen completely above the devices.

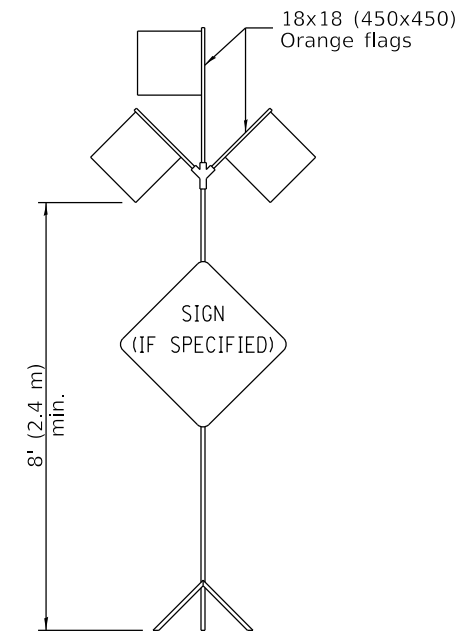

**HIGH LEVEL WARNING DEVICE**

ROAD CONSTRUCTION NEXT X MILES	END CONSTRUCTION
G20-I104(0)-6036	G20-I105(0)-6024

This signing is required for all projects 2 miles (3200 m) or more in length.  
 ROAD CONSTRUCTION NEXT X MILES sign shall be placed 500' (150 m) in advance of project limits.  
 END CONSTRUCTION sign shall be erected at the end of the job unless another job is within 2 miles (3200 m).  
 Dual sign displays shall be utilized on multi-lane highways.

**WORK LIMIT SIGNING**

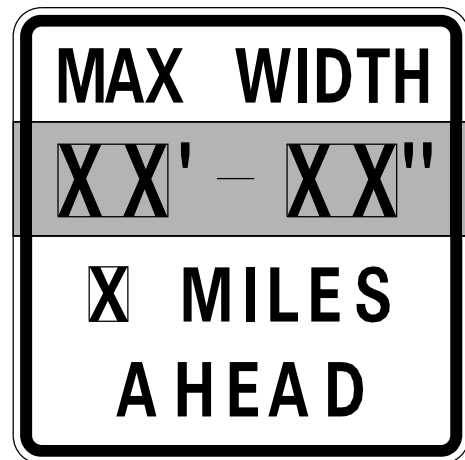

W12-I103-4848

**WIDTH RESTRICTION SIGN**

XX'-XX" width and X miles are variable.

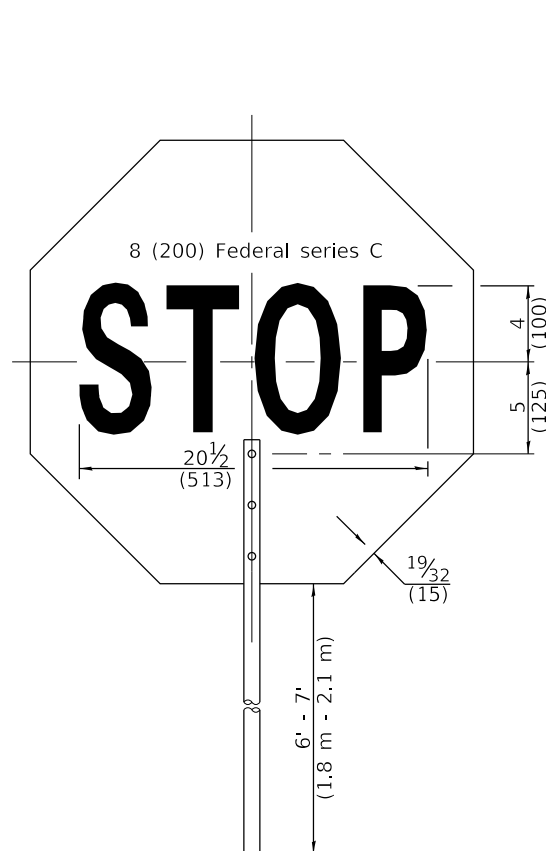

FRONT SIDE

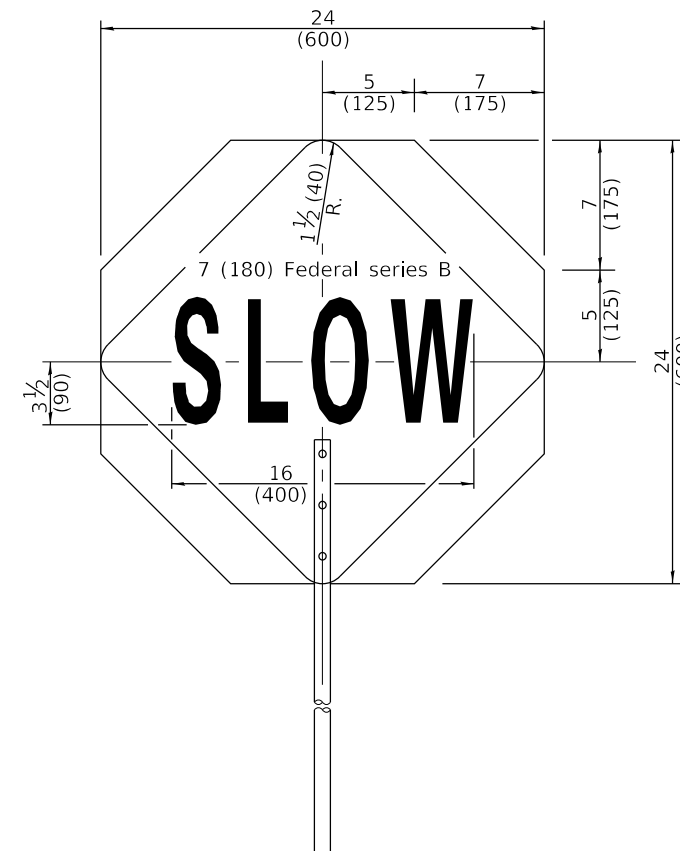

REVERSE SIDE

**FLAGGER TRAFFIC CONTROL SIGN**

WORK ZONE	W21-III5(0)-3618
SPEED LIMIT XX	R2-1-3648
PHOTO ENFORCED	R10-I108p-3618 ****
\$XXX FINE MINIMUM	R2-I106p-3618

Sign assembly as shown on Standards or as allowed by District Operations.

END WORK ZONE SPEED LIMIT	G20-I103-6036
---------------------------	---------------

This sign shall be used when the above sign assembly is used.

**HIGHWAY CONSTRUCTION SPEED ZONE SIGNS**

\*\*\*\* R10-I108p shall only be used along roadways under the jurisdiction of the State.

**TRAFFIC CONTROL DEVICES**

(Sheet 2 of 3)

**STANDARD 701901-08**

Illinois Department of Transportation

APPROVED January 1, 2019  
*[Signature]*  
 ENGINEER OF SAFETY PROG. AND ENGINEERING

APPROVED January 1, 2019  
*[Signature]*  
 ENGINEER OF DESIGN AND ENVIRONMENT

ISSUED 1-1-13

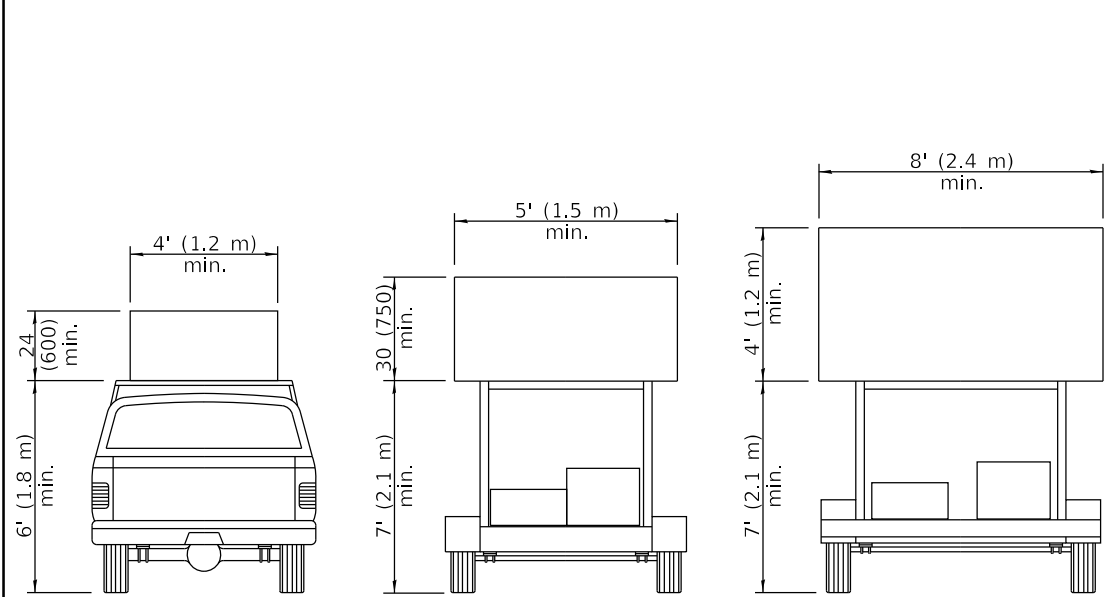

**TYPE A  
ROOF  
MOUNTED**

**TYPE B  
ROOF OR TRAILER  
MOUNTED**

**TYPE C  
TRAILER  
MOUNTED**

**ARROW BOARDS**

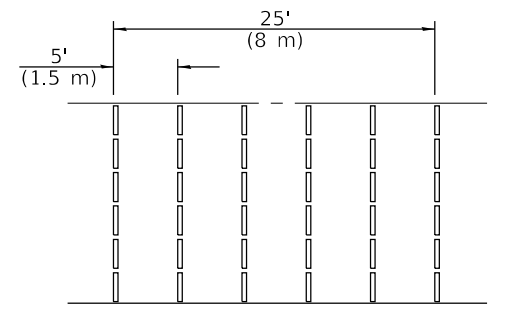
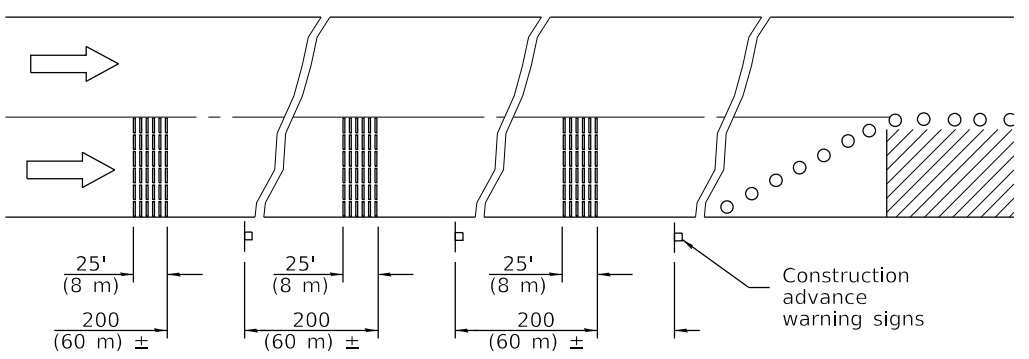
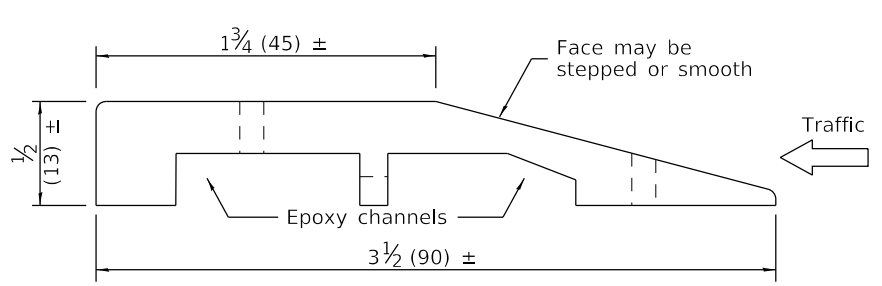
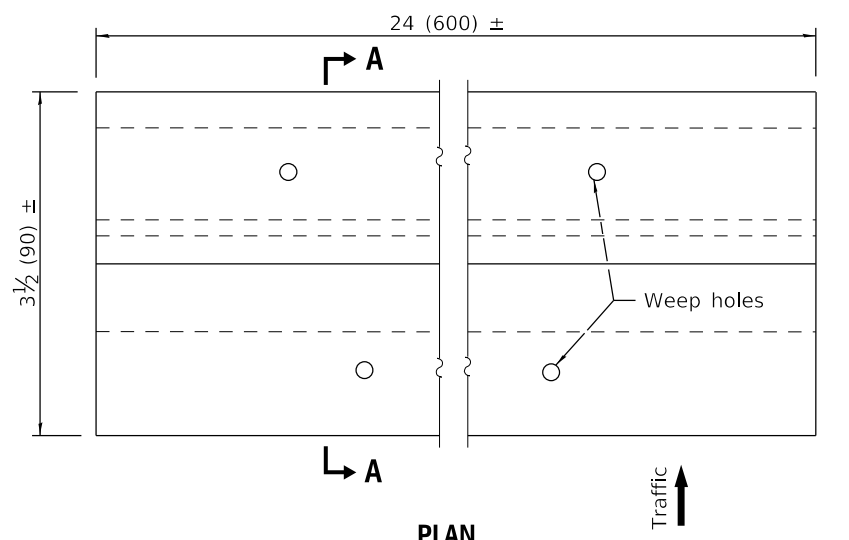

**TEMPORARY RUMBLE STRIPS**

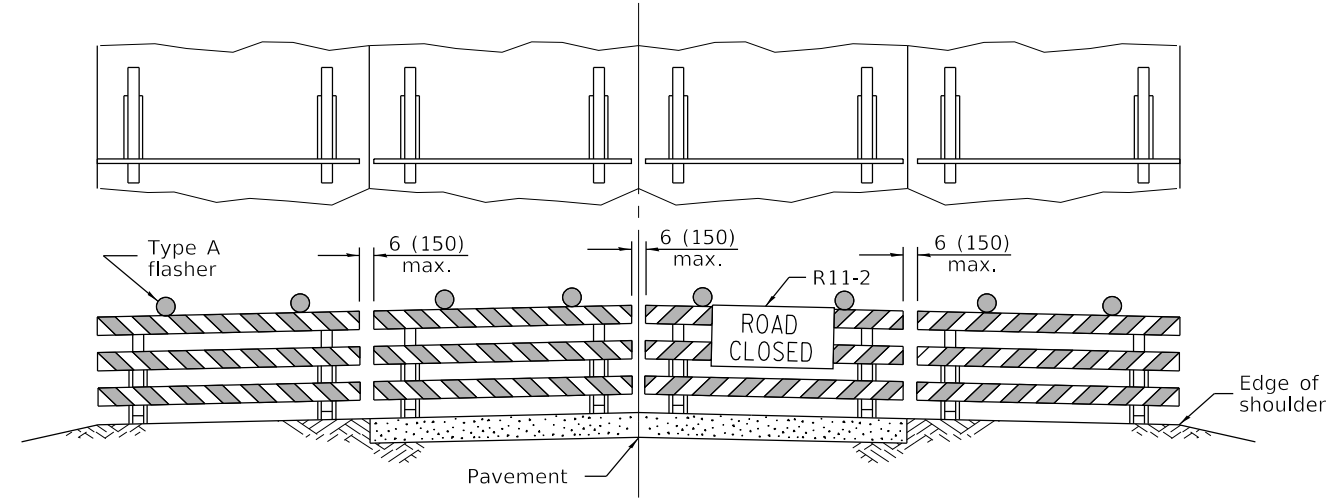

ROAD CLOSED TO ALL TRAFFIC

Reflectorized striping may be omitted on the back side of the barricades. If a Type III barricade with an attached sign panel which meets NCHRP 350 is not available, the sign may be mounted on an NCHRP 350 temporary sign support directly in front of the barricade.

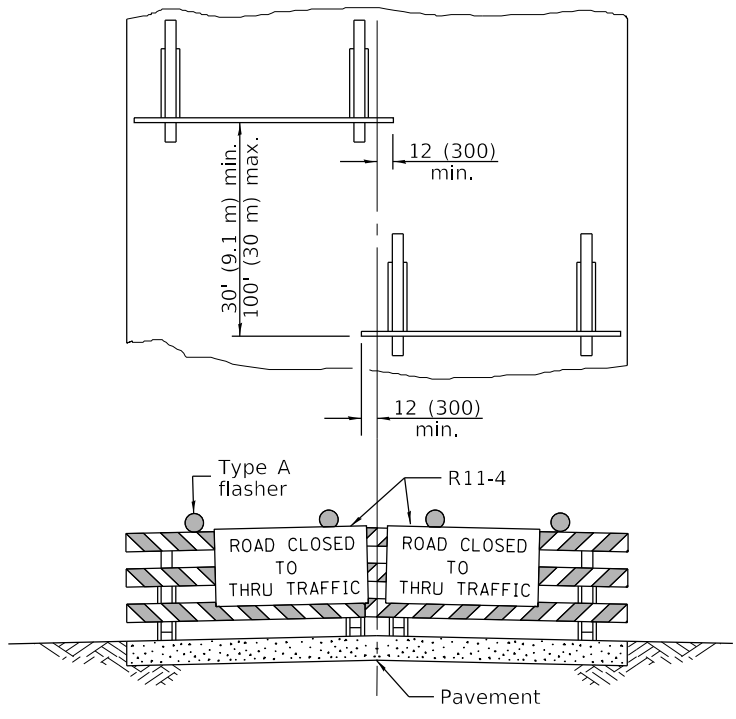

ROAD CLOSED TO THRU TRAFFIC

Reflectorized striping shall appear on both sides of the barricades. If a Type III barricade with an attached sign panel which meets NCHRP 350 is not available, the signs may be mounted on NCHRP 350 temporary sign supports directly in front of the barricade.

**TYPICAL APPLICATIONS OF  
TYPE III BARRICADES CLOSING A ROAD**

**TRAFFIC CONTROL  
DEVICES**

(Sheet 3 of 3)

**STANDARD 701901-08**

Illinois Department of Transportation

APPROVED January 1, 2019

*Cynthia Watt*  
ENGINEER OF SAFETY PROG. AND ENGINEERING

APPROVED January 1, 2019

*Joe E. ...*  
ENGINEER OF DESIGN AND ENVIRONMENT

ISSUES  
E1-1-1 Q3581